

- En Instruction Manual
- De Bauanleitung
- Fr Manuel de montage

# HB8T evo3

COMPETITION 1/8 SCALE 4WD ELECTRIC TRUGGY



## Thank you

Thank you for selecting this HB Racing product! This kit is designed to be fun to drive and uses top quality parts for durability and performance. The instruction manual you are reading was designed to be easy to follow yet thorough in its explanations. HB Racing wants you to enjoy driving your new HB Racing product. If you come across any problems or need some help getting through a step, give us a call and we will do our very best to help you. You can also contact us on the internet at [www.hbracing.com](http://www.hbracing.com)

- This is a high performance R/C kit, and it requires regular maintenance for best performance. If you don't do regular maintenance the performance will suffer. HB Racing has all the necessary parts and accessories available to keep your car performing at its best.

The caution or attention symbols will warn you about steps that can be very dangerous. Please read and understand the instructions carefully before proceeding.



### Caution

Failure to follow these instructions can damage your kit, and cause serious bodily injury or death.



### Attention

Failure to follow these instructions can cause injury to yourself or others. You might also cause property damage or damage to your kit.



### Caution

#### Before Running

- Please read manual with parent or guardian (responsible adult).

#### Before Operating

- Make sure that all screws and nuts are properly tightened.
- Always use fresh batteries for transmitter and receiver to avoid losing control of the model.
- Make sure no one else is using the same radio frequency as you are using.
- Please confirm the range of the radio operation.

#### During Running

- Please do not run on a public street, this could cause serious accidents, personal injuries and/or property damage.
- Please do not run near pedestrians or small children.
- Please do not run in small or confined areas.

#### After Running

- Turn OFF receiver first, then turn OFF transmitter. This will prevent the car from losing control.

#### Battery Safety

- Please be careful when handling the battery. It will be hot after running. If the wire is frayed, a short circuit can cause a fire.



# 4 TIME WORLD CHAMPIONS

[www.HBRACING.COM](http://www.HBRACING.COM)

## Danke

Vielen Dank, dass Sie sich für HB Racing entschieden haben! Dieses Auto soll Spaß machen und verwendet nur hochwertige Materialien für beste Leistungen und Haltbarkeit. Die Anleitung, die Sie gerade lesen, ist einfach zu verstehen und dabei sehr ausführlich. HB Racing will, dass Sie Erfolg und Spaß mit Ihrem neuen Modell haben! Falls es dennoch einmal zu Problemen kommen sollte, melden Sie sich bei uns. Wir werden alles in unserer Macht stehende tun, um zu helfen. Sie können uns auch gerne unter [www.hbracing.com](http://www.hbracing.com) kontaktieren.

- Dies ist ein hochleistungs RC-Auto und benötigt regelmäßige Wartung. Wenn Sie diese Wartungsarbeiten nicht durchführen wird die Leistung des Autos darunter leiden. Alle zur Wartung benötigten Teile sind bei HB Racing erhältlich.

Die Warnsymbole weisen Sie auf gefährliche Bauabschnitte hin.  
Bitte lesen und verstehen Sie die Anweisungen bevor Sie sie durchführen.



### Warnhinweise

Wenn Sie diesen Anweisungen nicht folgen, können Sie oder Ihr Auto Schäden davontragen.



### Achtung

Wenn Sie diesen Anweisungen nicht folgen, können Sie oder andere verletzt werden. Es kann auch sein, dass dabei Sachschaden an anderen Dingen oder Ihrem Auto entsteht.



### Warnhinweise

#### Vor dem Fahren

- Bitte lesen Sie die Anleitung (zusammen mit einem Erwachsenen/Erziehungsberechtigten).

#### Vor dem Betrieb

- Stellen Sie sicher, dass alle Schrauben und Muttern korrekt sitzen.
- Verwenden Sie immer volle Batterien für den Sender und Empfänger, um Empfangsstörungen zu vermeiden.
- Stellen Sie sicher, dass niemand anderes die gleiche Frequenz verwendet.
- Überprüfen Sie die Reichweite der RC-Anlage.

#### Während dem Fahren

- Fahren Sie nicht auf öffentlichen Straßen. Dies kann zu schweren Unfällen mit Personen- oder Sachschäden führen.
- Fahren Sie nicht in der Nähe von Fußgängern oder kleinen Kindern.
- Fahren Sie nicht auf zu kleinen oder zu eng begrenzten Geländen.

#### Nach dem Fahren

- Schalten Sie den Empfänger aus, dann erst den Sender. Dies verhindert, dass das Auto außer Kontrolle gerät.

#### Hinweise zum Fahrakku

- Geben Sie im Umgang mit dem Fahrakku bitte Acht. Er ist nach dem Fahren sehr heiß. Falls die Kabel beschädigt sind, kann ein Kurzschluss ein Feuer auslösen.

## Merci

Merci d'avoir choisi ce produit HB Racing! Ce kit a été conçu pour être amusant à conduire, et utilise des pièces de la plus haute qualité pour la longévité et les performances. Le manuel d'utilisation qui est entre vos mains a été conçu pour vous fournir des explications faciles à suivre mais complètes. HB Racing espère que vous aurez plaisir à piloter votre nouveau kit radio-commandé. Si vous rencontrez des problèmes ou si vous avez besoin d'aide pour une étape, appelez-nous et nous ferons de notre mieux pour vous aider. Vous pouvez aussi nous contacter par Internet sur [www.hbracing.com](http://www.hbracing.com).

- Ceci est un kit radio-commandé de hautes performances, et requiert un entretien régulier pour donner le meilleur de lui-même. Si vous n'effectuez pas un entretien régulier, les performances en souffriront. HB Racing a toutes les pièces et les accessoires nécessaires pour maintenir les performances de votre véhicule à leur meilleur niveau.

Les symboles attirant votre attention vous avertiront des étapes qui peuvent être très dangereuses. Veuillez lire soigneusement les instructions et bien les comprendre avant toute utilisation.



### Précautions

En ne suivant pas ces instructions vous pourriez endommager votre kit, et provoquer de sérieux dégâts corporels ou même mortels.



### Attention

En ne suivant pas ces instructions vous pourriez vous blesser vous-même ou blesser d'autres personnes. Vous pourriez également provoquer des dégâts matériels ou endommager votre kit.



### Précautions

#### Avant de mettre en marche

- Veuillez lire le manuel avec un parent ou un adulte responsable.

#### Avant de mettre en marche

- Vérifiez que toutes les vis et les boulons sont correctement serrés.
- Utilisez toujours des batteries nouvellement chargées pour l'émetteur et le récepteur afin d'éviter de perdre le contrôle du véhicule.
- Vérifiez que personne d'autre n'utilise la même fréquence radio que vous.
- Vérifiez le champ d'action du fonctionnement de la radio.

#### Pendant le fonctionnement

- Ne faites pas fonctionner sur une voie publique, cela pourrait provoquer des accidents graves, des blessures corporelles et/ou des dommages aux biens.
- Ne faites pas fonctionner à proximité de piétons ou d'enfants en bas âge.
- Ne faites pas fonctionner dans des lieux petits ou fermés.

#### Après l'arrêt

- Éteignez d'abord le récepteur, puis l'émetteur. Cela empêchera une éventuelle perte de contrôle du véhicule.

#### Sécurité de la batterie

- Faites très attention lorsque vous manipulez la batterie. Elle sera très chaude après utilisation. Si un câble était dénudé, un court-circuit pourrait provoquer un incendie.

**Equipment Needed**  
**Benötigtes Zubehör**  
**Équipement nécessaire**

**Transmitter**  
**Sender**  
**Émetteur**

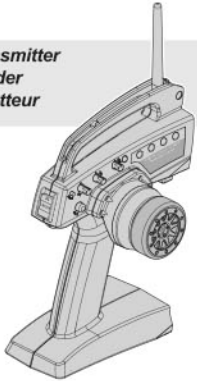

**Steering Servo**  
**Lenkservo**  
**Servo de direction**

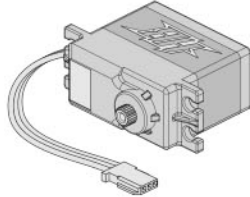

**Receiver**  
**Empfänger**  
**Récepteur**



**Electronic Speed Control (ESC)**  
**Elektronischer Fahrtenregler (ESC)**  
**Contrôleur de vitesse (ESC)**

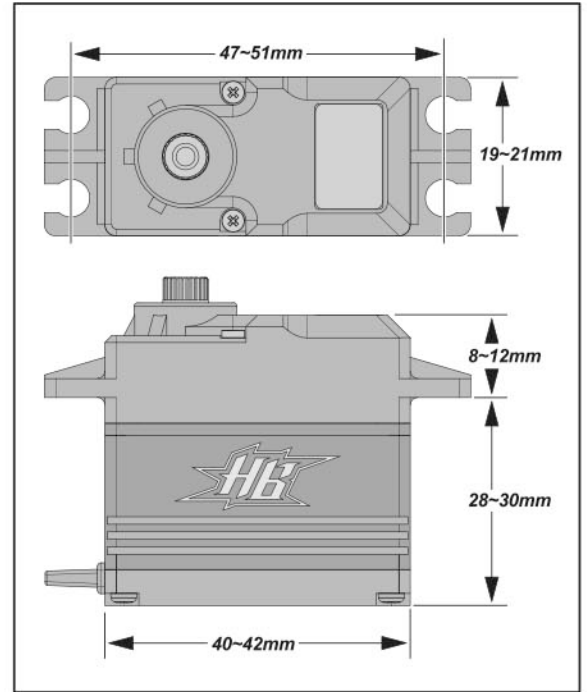
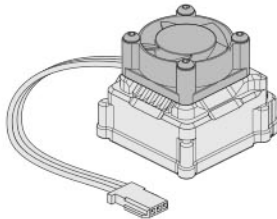

**Batteries for transmitter**  
**Senderbatterien**  
**Piles de l'émetteur**

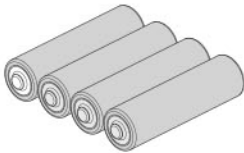

**Charger**  
**Ladegerät**  
**Chargeur**

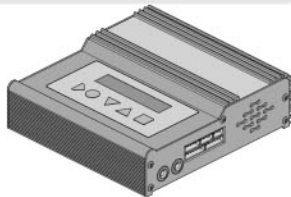

**Electric Motor**  
**Elektromotor**  
**Moteur électrique**

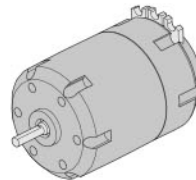

**Body**  
**Karosserie**  
**Carrosserie**

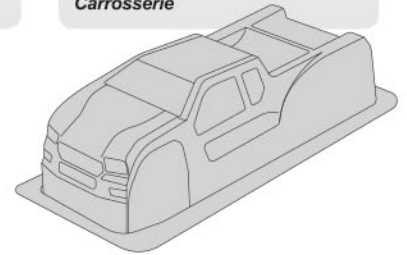

**Wheels and Tires**  
**Räder und Reifen**  
**Roues et Pneus**

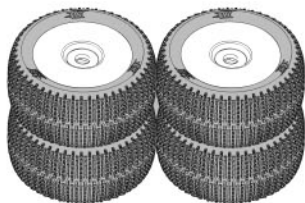

**Battery**  
**Fahrakku**  
**Batterie**

Accepts 4s 'brick' packs, 2 x 2s 'long' batteries, and 2 x 2s 'shorty' batteries (allows fore/aft weight adjustment).

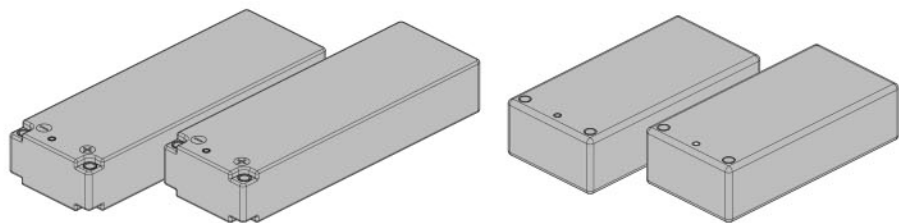

**Caution**  
**Warnhinweise**  
**Précautions**

If you do not use a charger designed to charge Nickel Metal Hydride / LiPo batteries, the batteries will be damaged.  
 Wenn Sie keinen geeigneten Lader zum Laden der Nickel-Metall-Hybrid oder LiPo Akkus verwenden, werden die Akkus beschädigt.  
 Si vous n'utilisez pas un chargeur conçu pour recharger les batteries Nickel Métal Hydride ou LiPo, celles-ci seront endommagées.

## Tools Werkzeuge Outils

Tools needed for assembly. Sold separately.  
Zum Zusammenbau benötigtes Werkzeug. Separat erhältlich.  
Outils nécessaires pour la mise en place, vendus séparément.

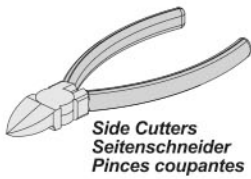

Side Cutters  
Seitenschneider  
Pincés coupantes

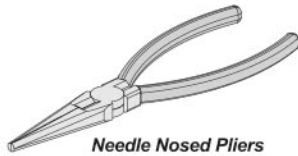

Needle Nosed Pliers  
Flachzange  
Pince à bec fin

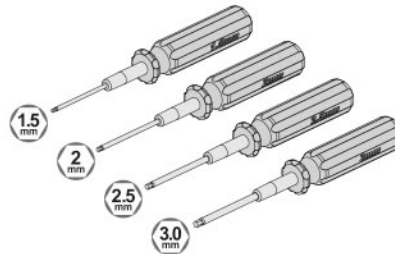

Allen Wrench 1.5mm / 2.0mm / 2.5mm / 3.0mm  
Inbusschlüssel 1.5mm / 2.0mm / 2.5mm / 3.0mm  
Clé Allen 1.5mm / 2.0mm / 2.5mm / 3.0mm

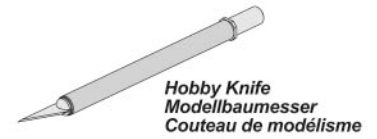

Hobby Knife  
Modellbaumesser  
Couteau de modélisme

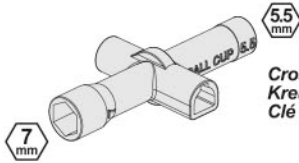

Cross Wrench  
Kreuzschlüssel  
Clé en croix

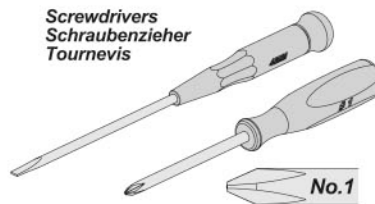

Screwdrivers  
Schraubenzieher  
Tournevis



Reamer  
Karosserieloch-Bohrer  
Alésoir



Turnbuckle Wrench  
Spurstangenschlüssel  
Clé à biellettes

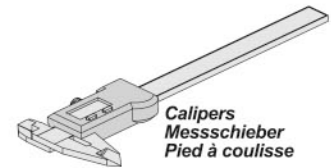

Calipers  
Messschieber  
Pied à coulisse

Thread Lock  
Schraubensicherung  
Frein A Filet



Grease  
Fett  
Graisse



Instant Cement  
Sekundenkleber  
Colle rapide



Air Filter Oil  
Luftfilter Öl  
Huile p. Filtre a air



Lexan Paint  
Lexanfarbe  
Peinture



## Included Items Enthaltenes Werkzeug Éléments inclus



ORI44406  
Silicone Oil #400  
Silikon Daempferoel #400  
Huile silicone 400



ORI44417  
Silicone Oil #4000  
Silikon Daempferoel #4000  
Huile silicone 4000



ORI44420  
Silicone Oil #7000  
Silikon Daempferoel #7000  
Huile silicone 7000

## Caution Achtung Attention



Do not run in water or sand.  
Fahren Sie nie in Wasser oder Sand.  
Ne faites pas fonctionner dans l'eau ou sur le sable.

Do not run on public streets or highways. This could cause serious accidents, personal injuries, and/or property damage.  
Fahren Sie niemals auf öffentlichen Straßen. Dies kann zu schweren Unfällen mit Personen- und Sachschaden führen.  
Ne faites pas fonctionner sur la voie publique ou la route. Cela pourrait provoquer des accidents graves, des blessures corporelles ou des dommages aux biens.

## STEP A-01

### UPDATES

Check [www.hbracing.com](http://www.hbracing.com) for the latest updates to the instructions.

Front  
Vorne  
Avant

**2x** Make 2  
2 Stück 2 fois

Rear  
Hinten  
Arrière

**2x** Make 2  
2 Stück 2 fois

#### SETUP SHEET

See Set-Up Sheet on Page 33 or [hbracing.com](http://hbracing.com)

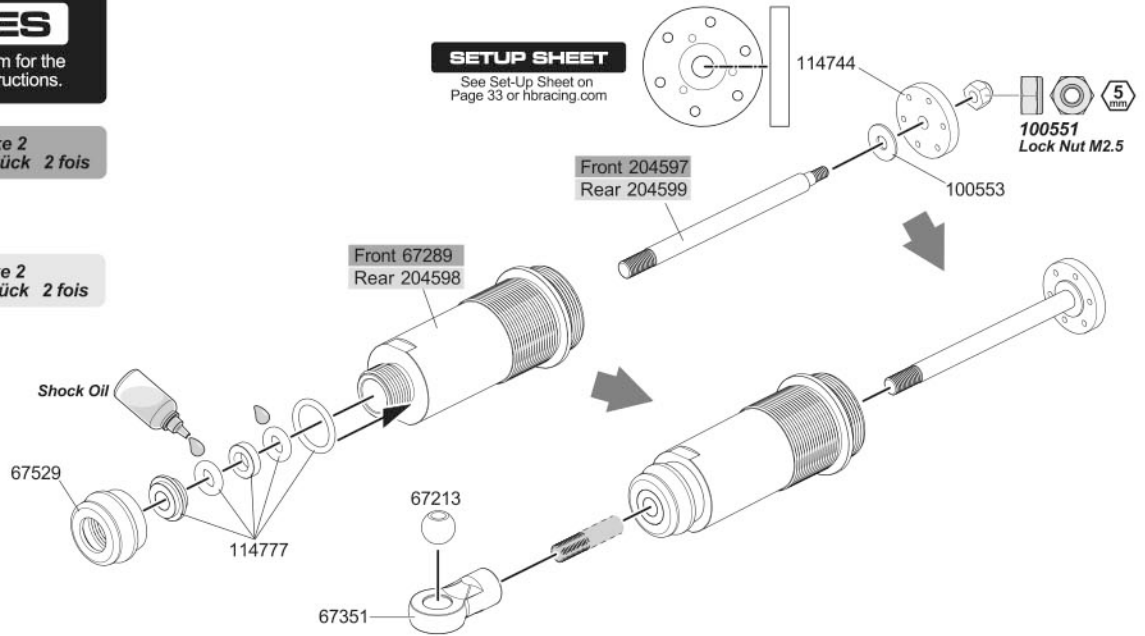

Move the shaft up and down slowly to remove all air bubbles.  
Bewegen Sie die Kolbenstange langsam nach oben und unten, damit Luftblasen entweichen können.  
Déplacez l'axe vers le haut et vers le bas doucement pour faire partir toutes les bulles.

ORI44406  
Silicone Oil #400  
Silikon Daempferoel #400  
Huile silicone 400

#### SETUP SHEET

See Set-Up Sheet on Page 33 or [hbracing.com](http://hbracing.com)

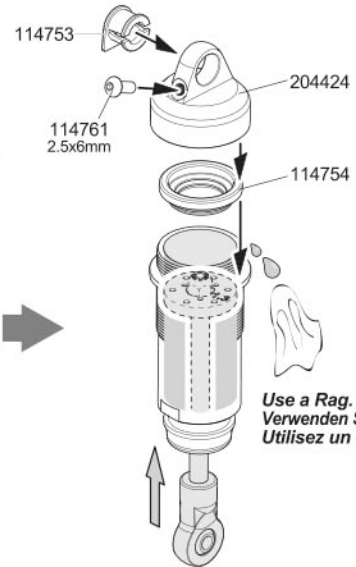
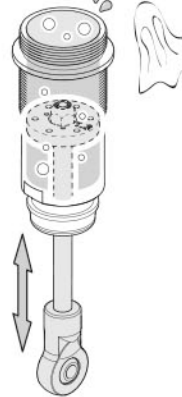

Use a Rag.  
Verwenden Sie einen Putzlappen.  
Utilisez un chiffon.

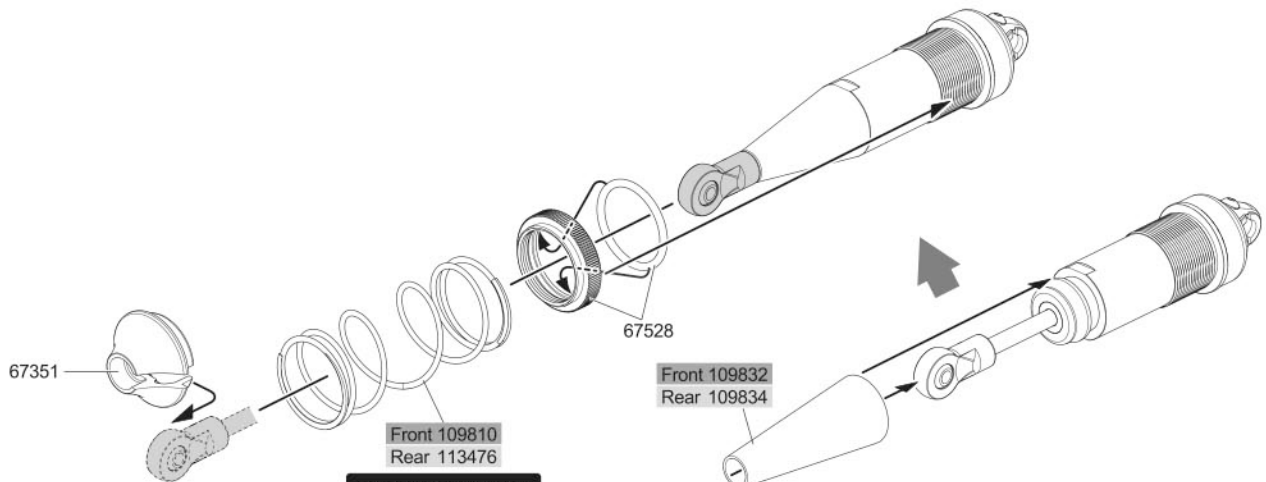

#### SETUP SHEET

See Set-Up Sheet on Page 33 or [hbracing.com](http://hbracing.com)

## STEP B-01

Front  
Vorne  
Avant

**1x** Make 1  
1 Stück 1 fois

Rear  
Hinten  
Arrière

**1x** Make 1  
1 Stück 1 fois

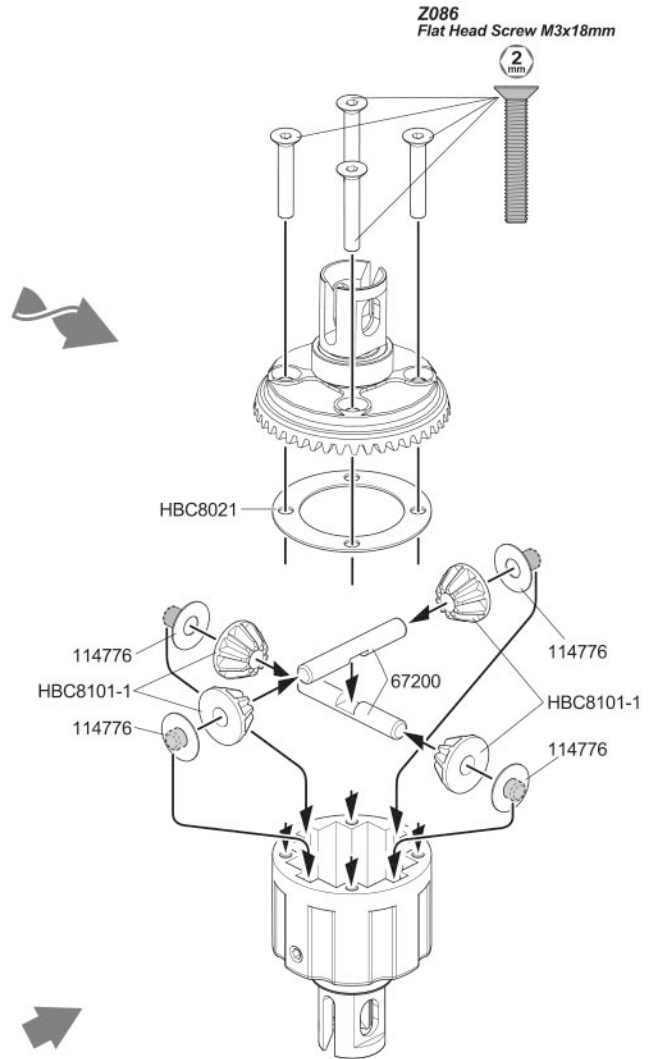
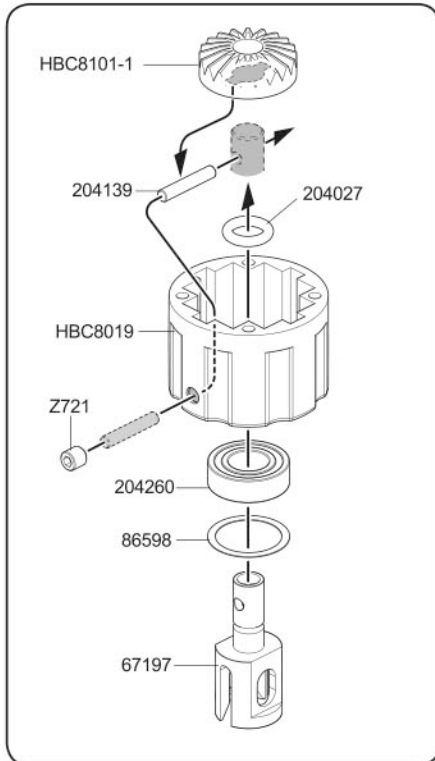
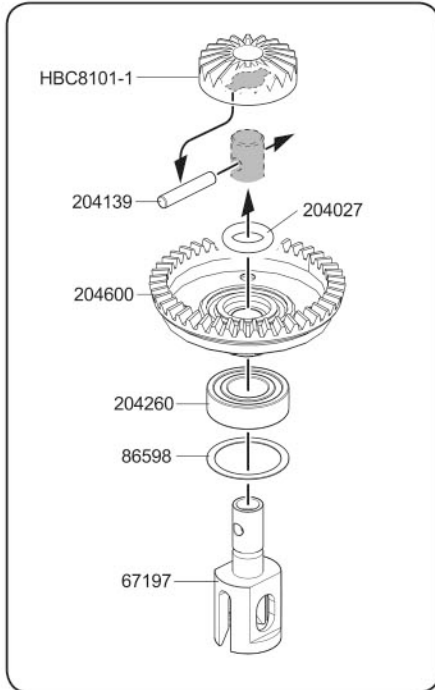

### SETUP SHEET

See Set-Up Sheet on  
Page 33 or hbracing.com

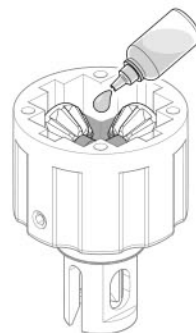

**#7,000**

**Front  
Vorne  
Avant**

ORI44420  
Silicone Oil #7,000  
Silikon Daempferoel #7,000  
Huile silicone 7,000

**#4,000**

**Rear  
Hinten  
Arrière**

ORI44417  
Silicone Oil #4,000  
Silikon Daempferoel #4,000  
Huile silicone 4,000

Fill to top of cross shafts with silicone diff oil.  
Füllen Sie das Gehäuse bis zum Wellenkreuz  
mit Silikon-Differential-Öl.

Remplissez d'huile jusqu'en haut des arbres trans-  
versaux avec de l'huile silicone pour différentiel.

## STEP B-02

Center  
Mitte  
Central

**1x** Make 1  
1 Stück 1 fois

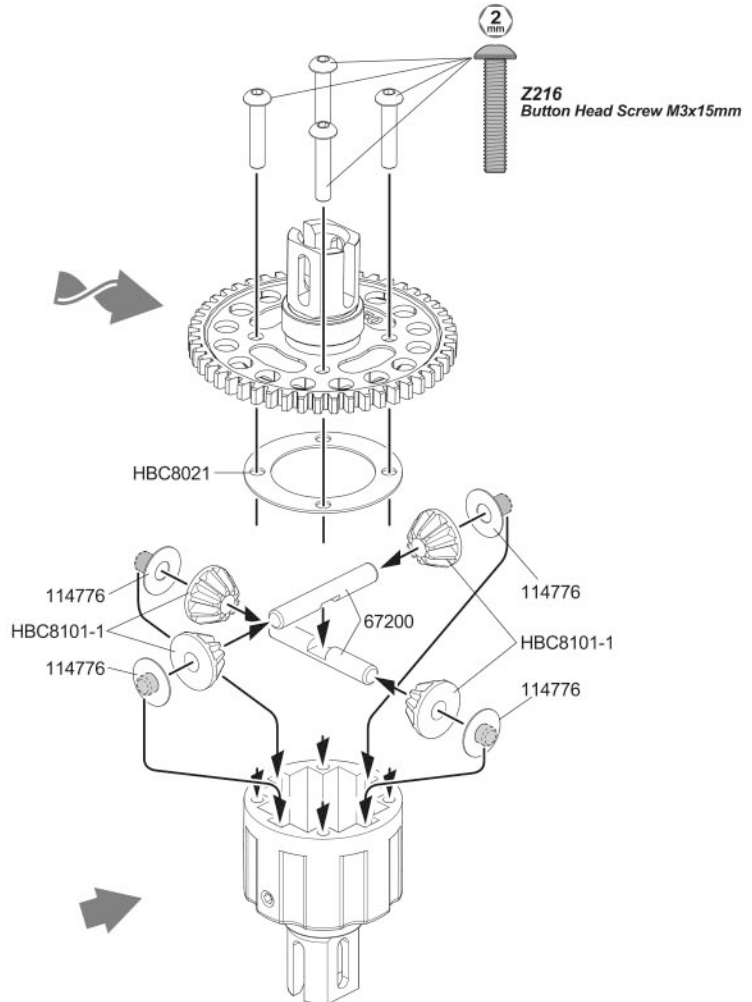
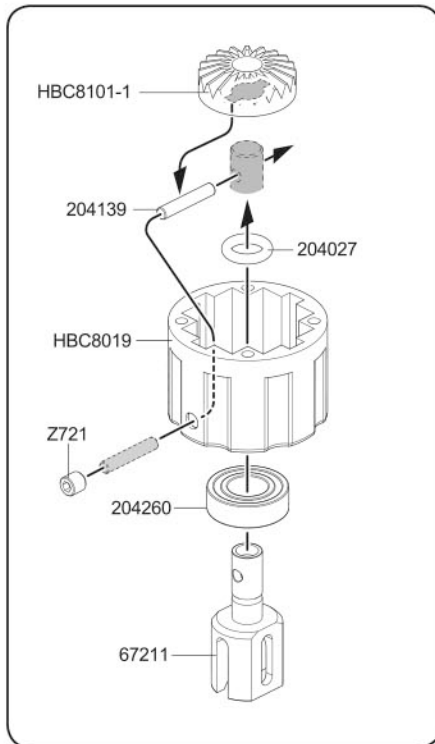
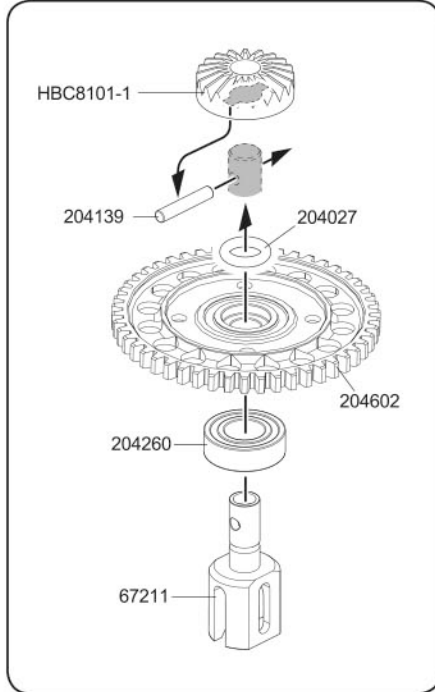

### SETUP SHEET

See Set-Up Sheet on  
Page 33 or [hbracing.com](http://hbracing.com)

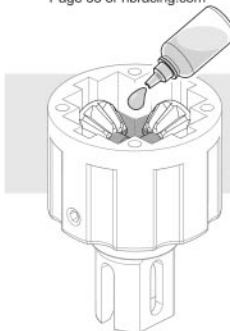

## #7,000

ORI44420  
Silicone Oil #7,000  
Silikon Daempferoel #7,000  
Huile silicone 7,000

Fill to top of cross shafts with silicone diff oil.  
Füllen Sie das Gehäuse bis zum Wellenkreuz  
mit Silikon-Differential-Öl.  
Remplissez d'huile jusqu'en haut des arbres trans  
versaux avec de l'huile silicone pour différentiel.



## STEP C-01

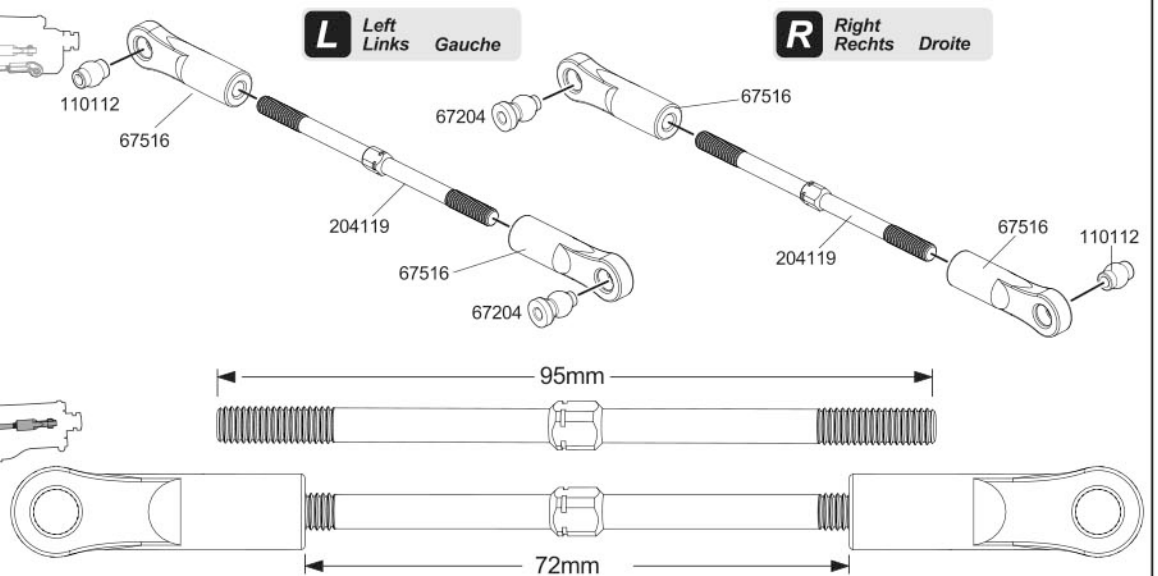
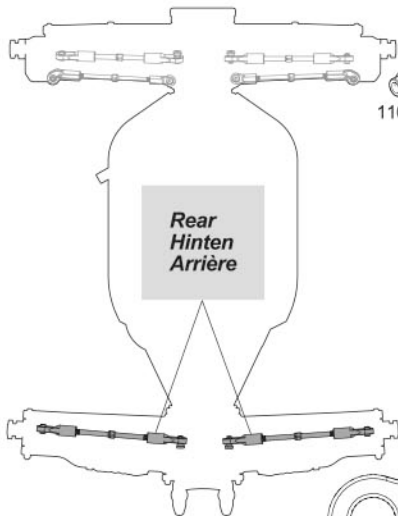
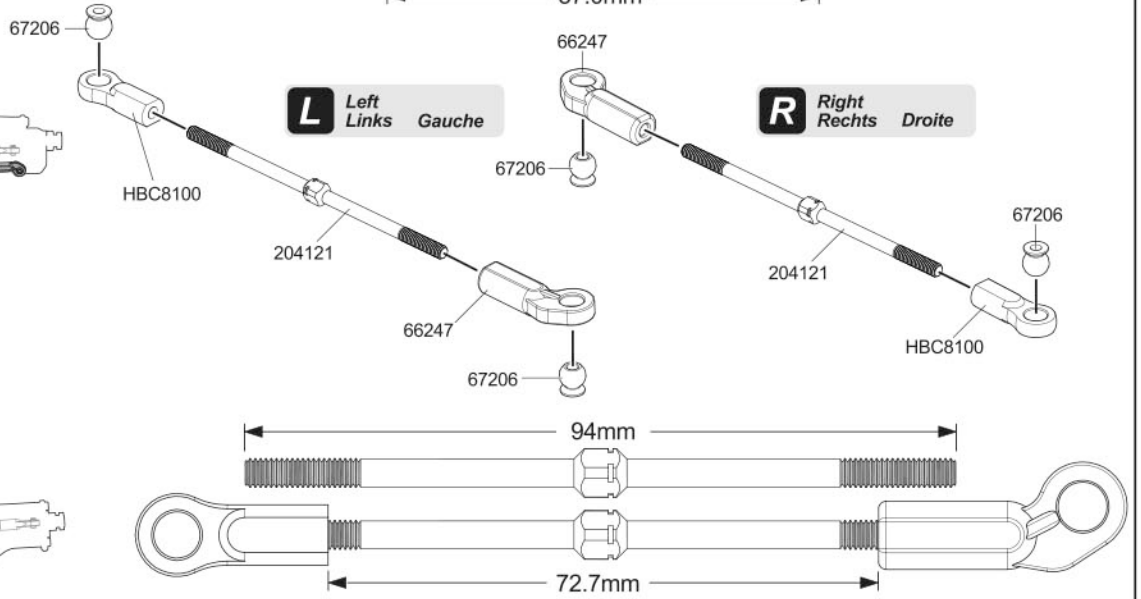
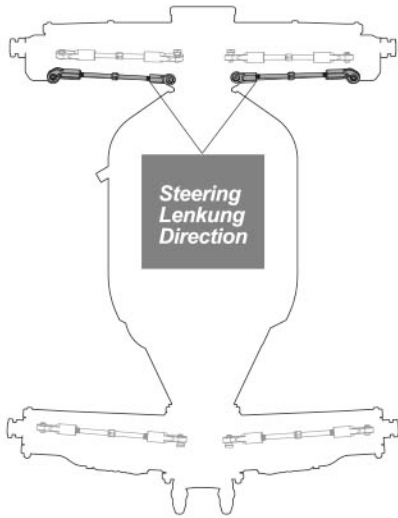
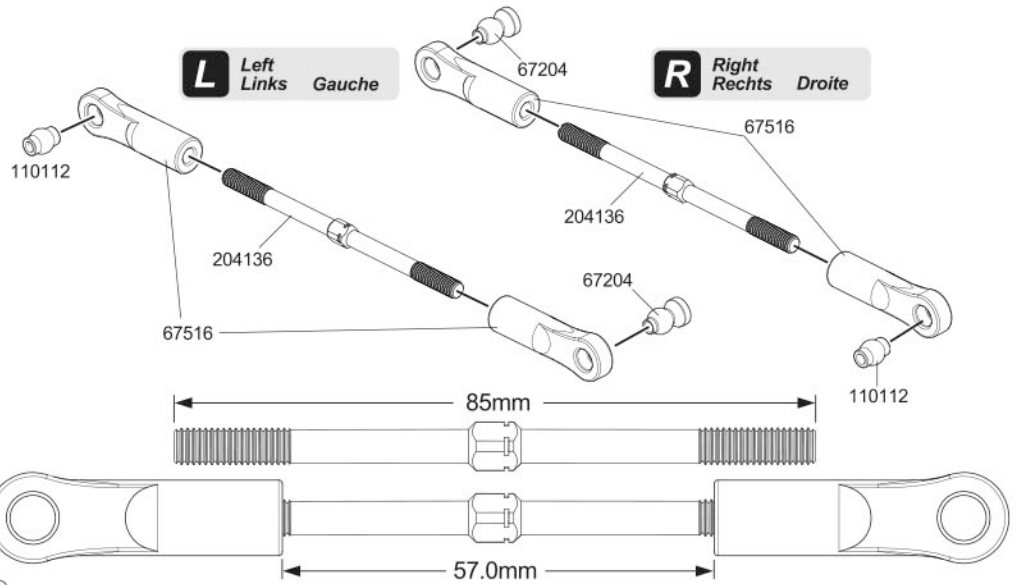
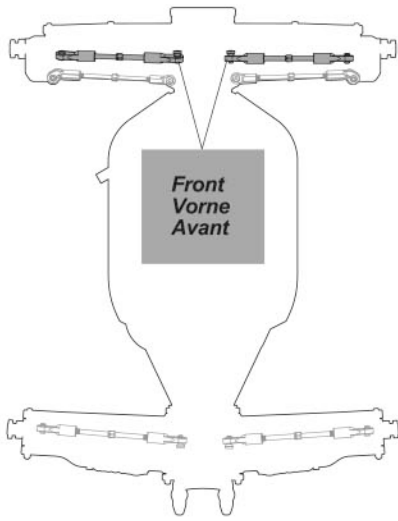

# BAG-D

## STEP D-01

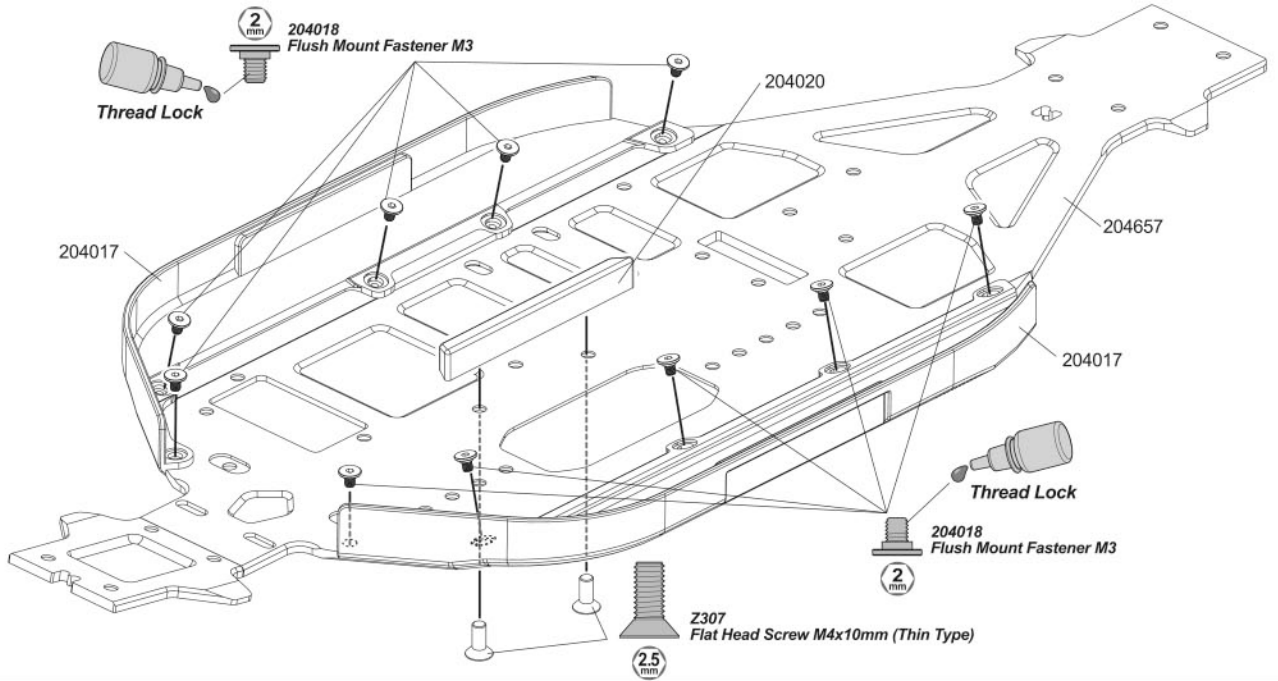

# BAG-E

## STEP E-01

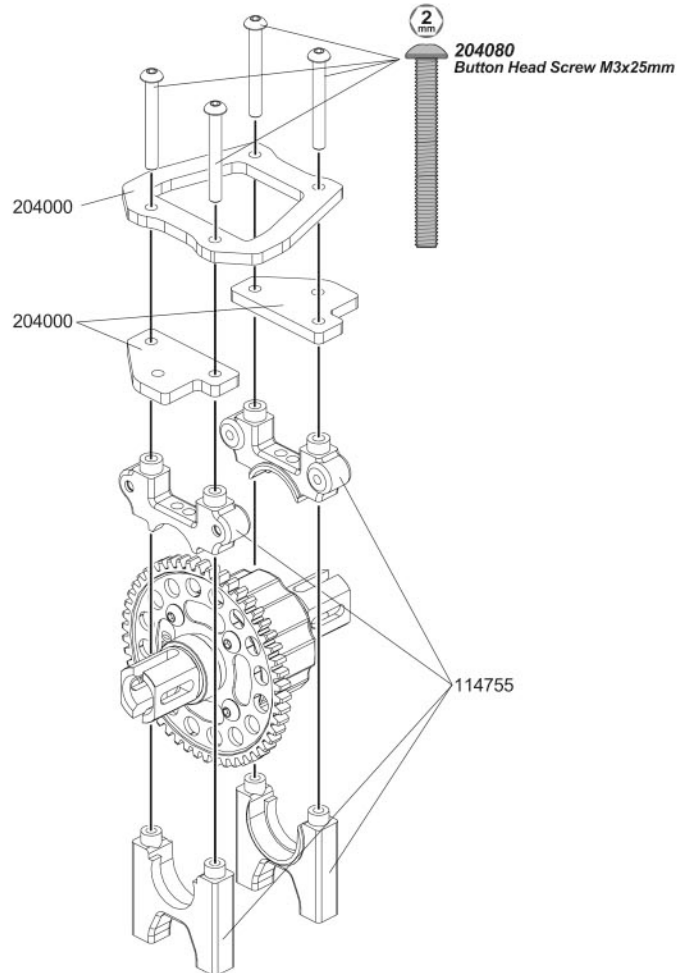

# BAG - E

## STEP E-02

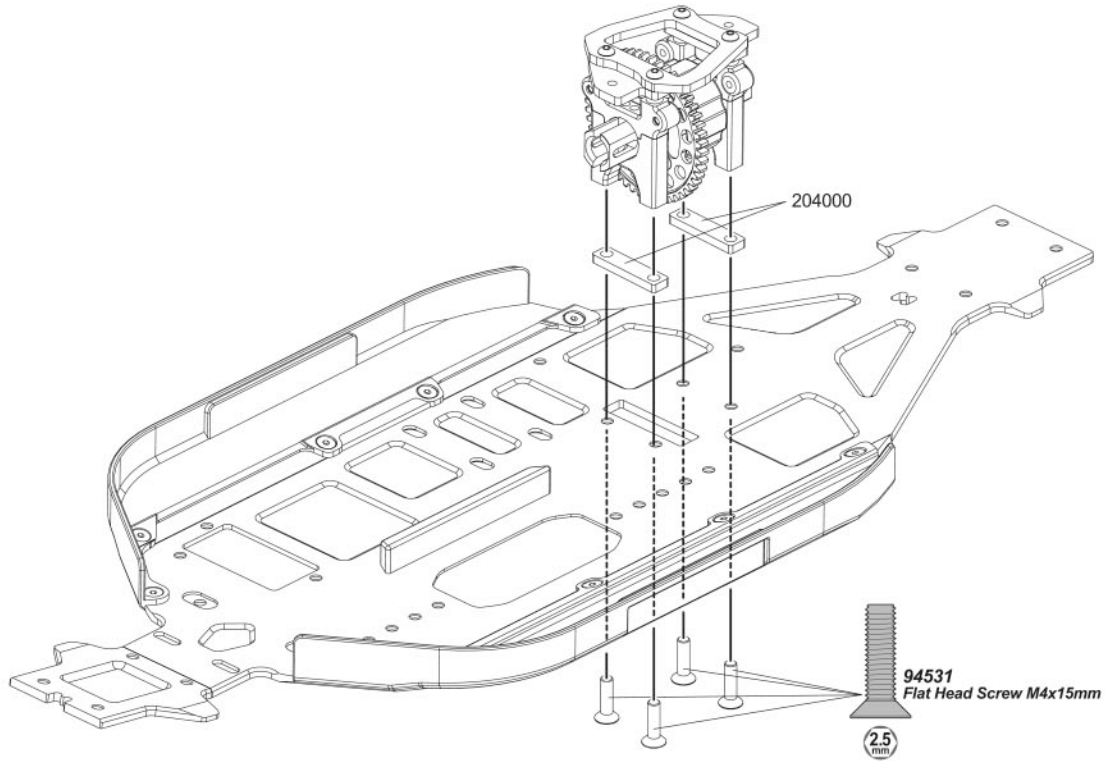

# BAG - F

## STEP F-01

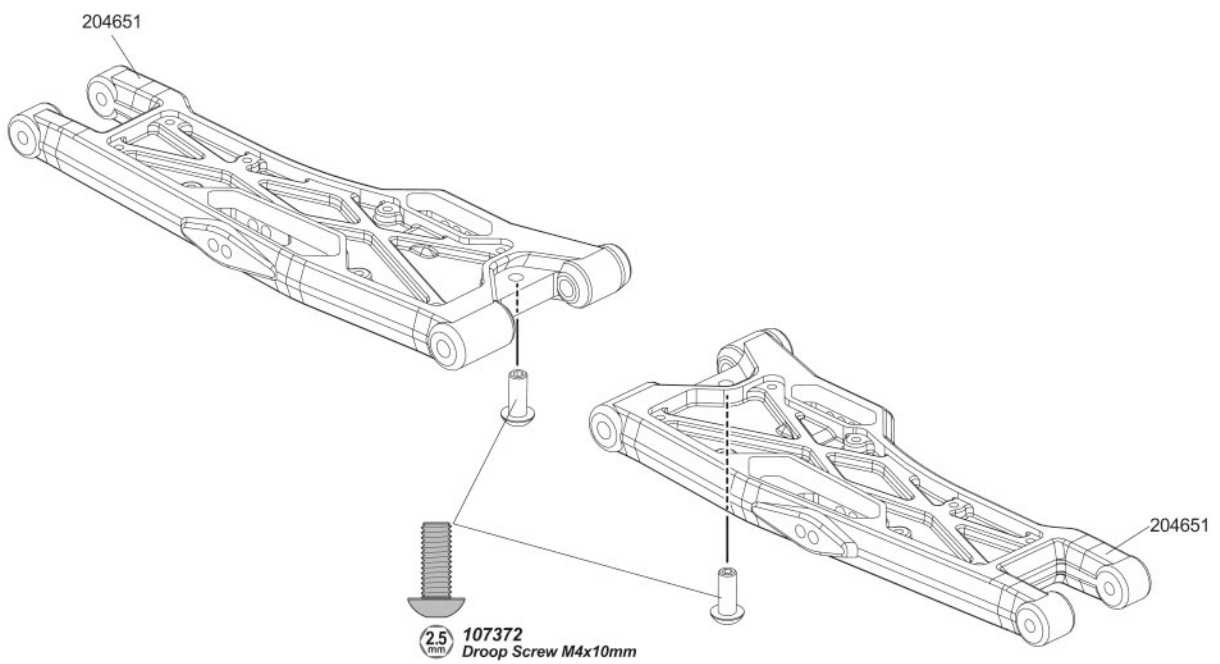

## STEP F-02

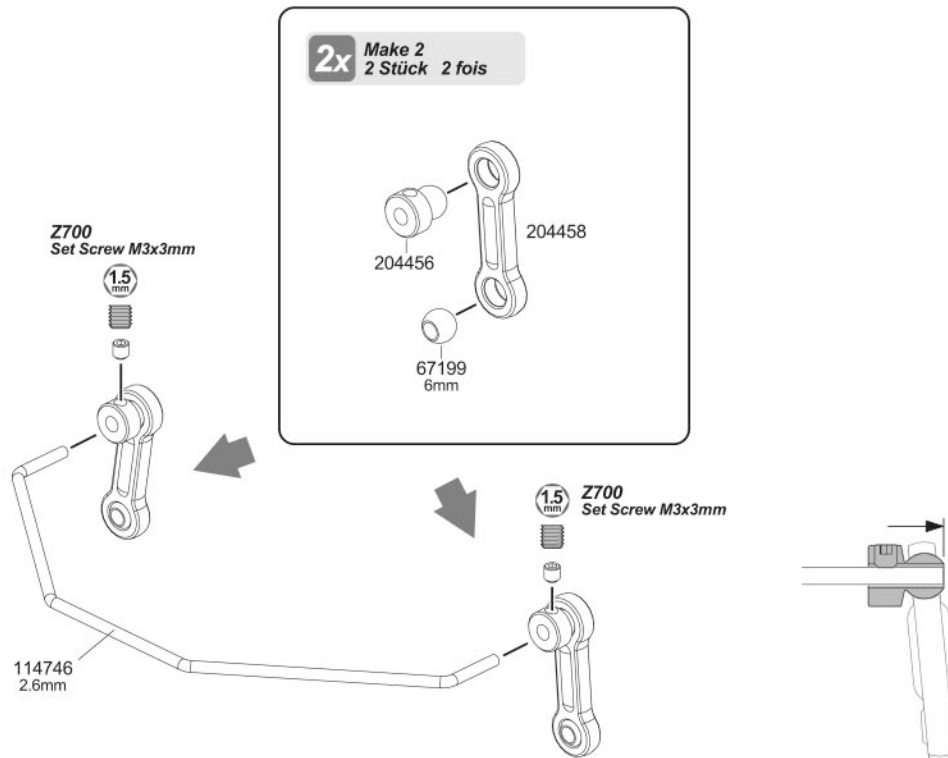

Visit

[www.HBRACING.com](http://www.HBRACING.com)

- Latest set-up sheets
- Instruction updates
- Newest option parts
- Team info
- Race news



## STEP F-03

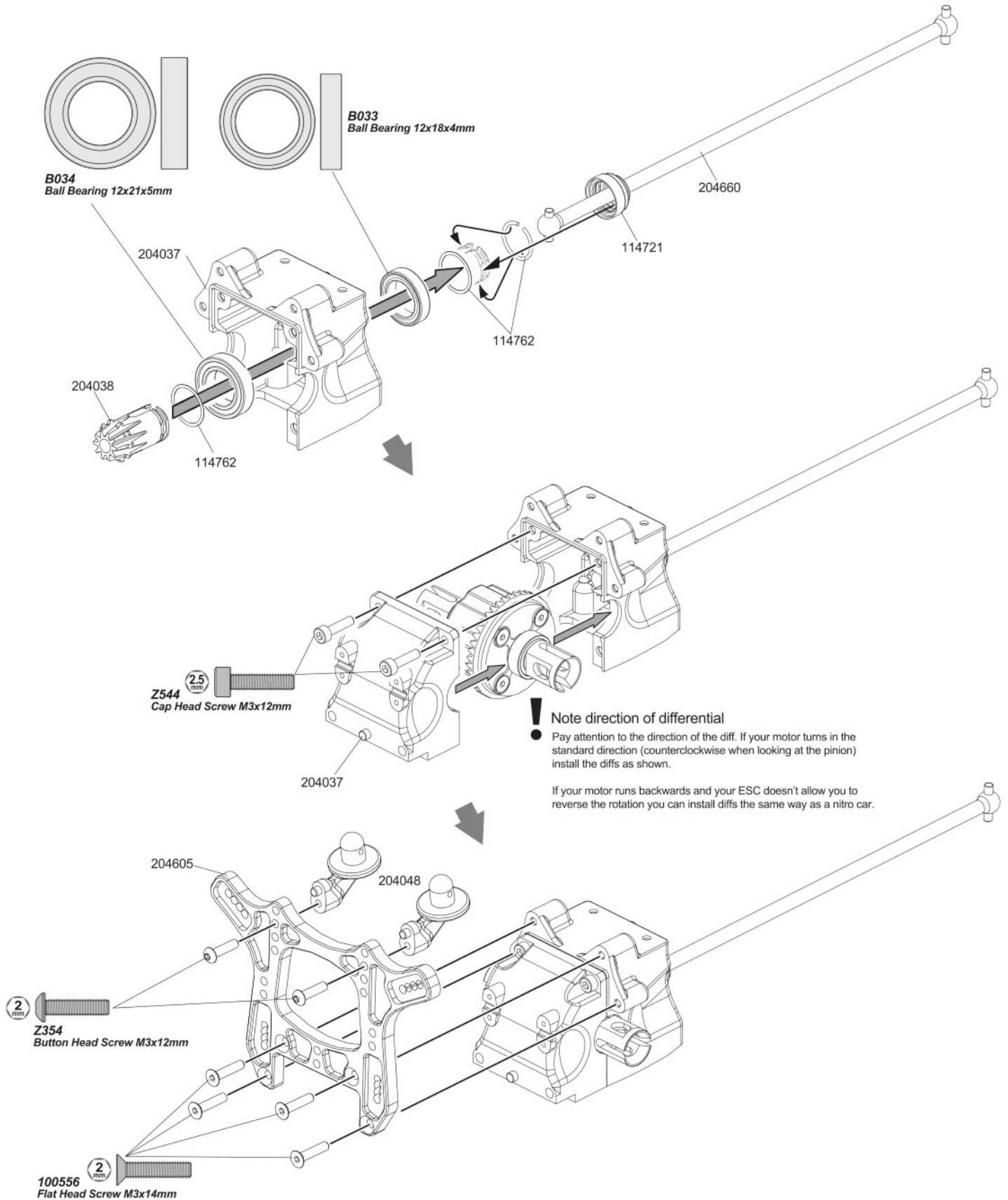

## STEP F-04

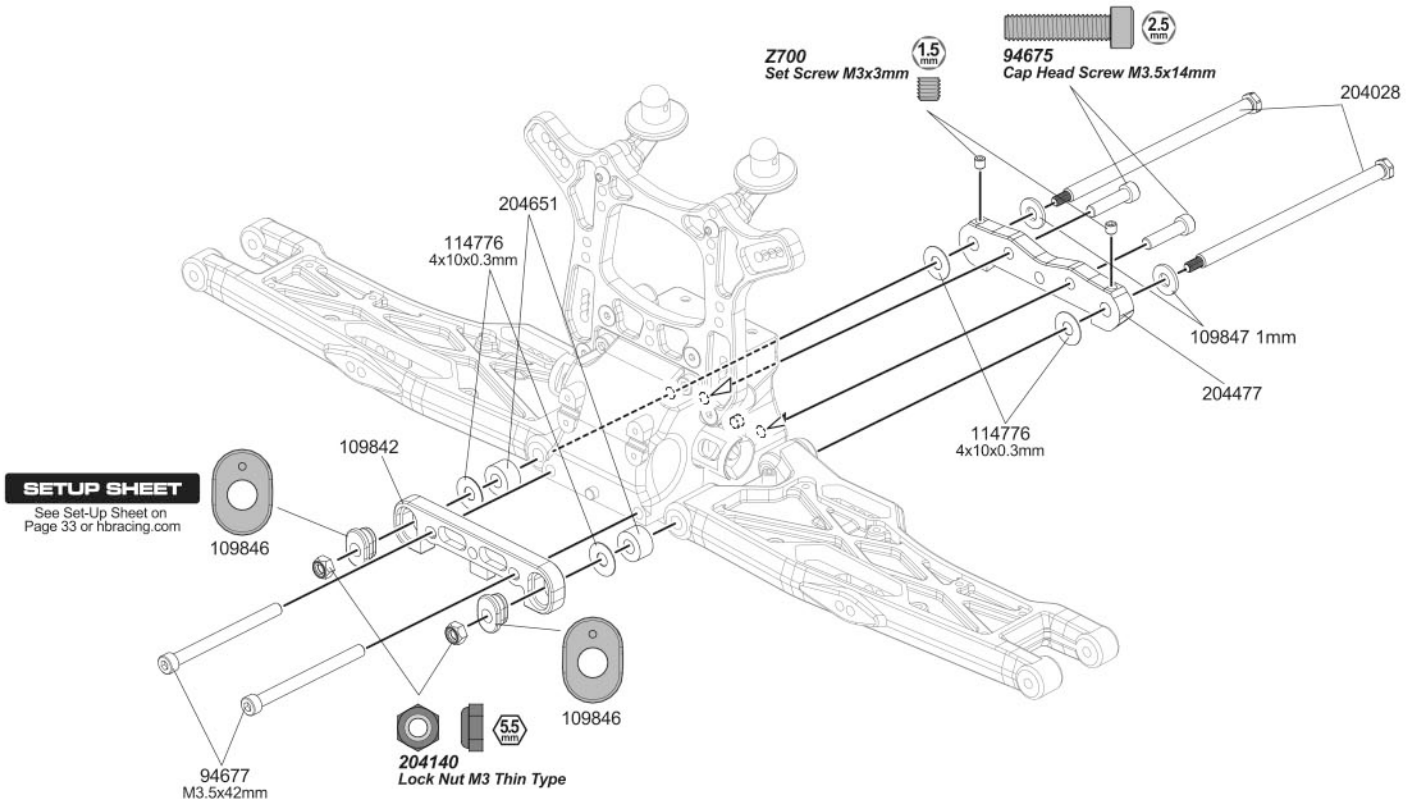

## STEP F-05

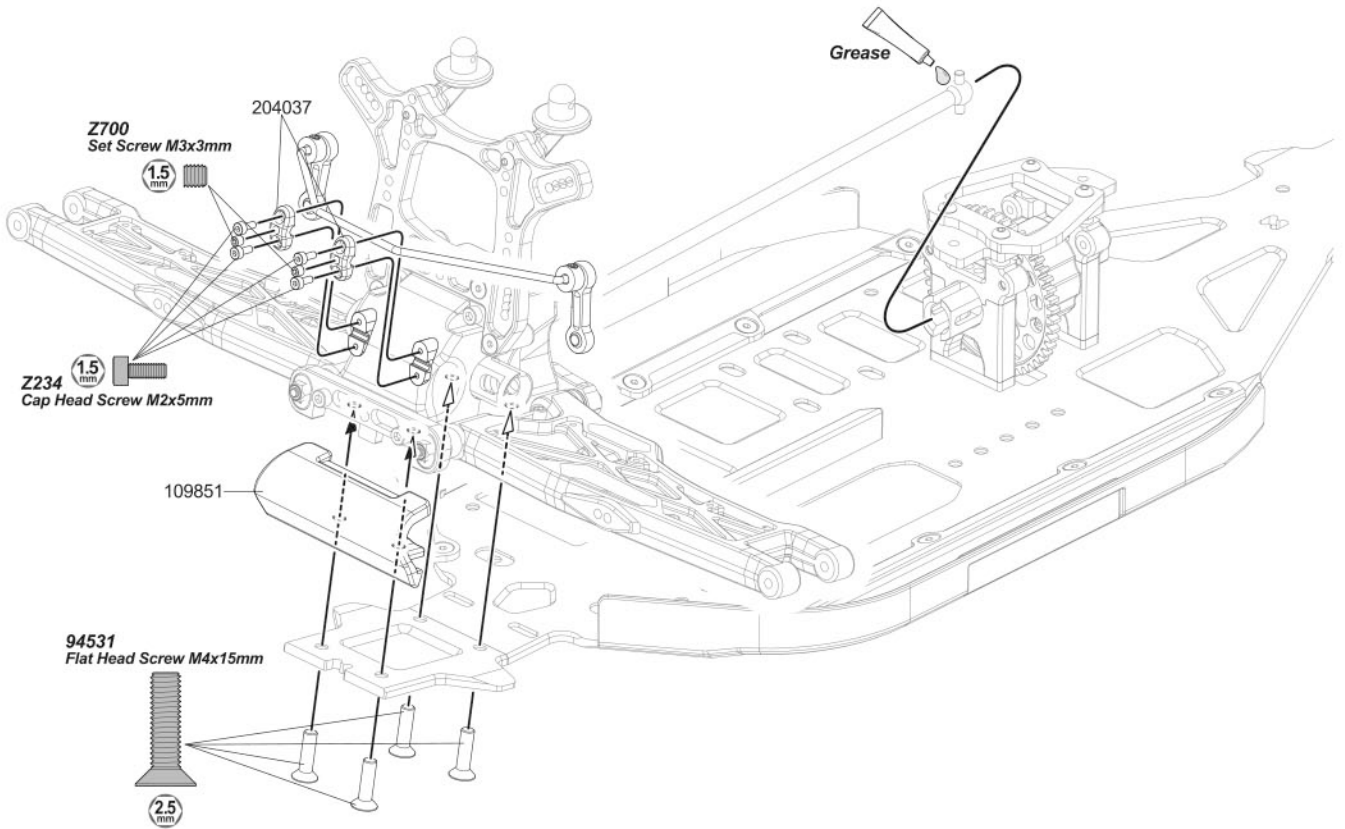

## STEP F-06

**R** Right Droite  
Rechts

**L** Left Links  
Gauche

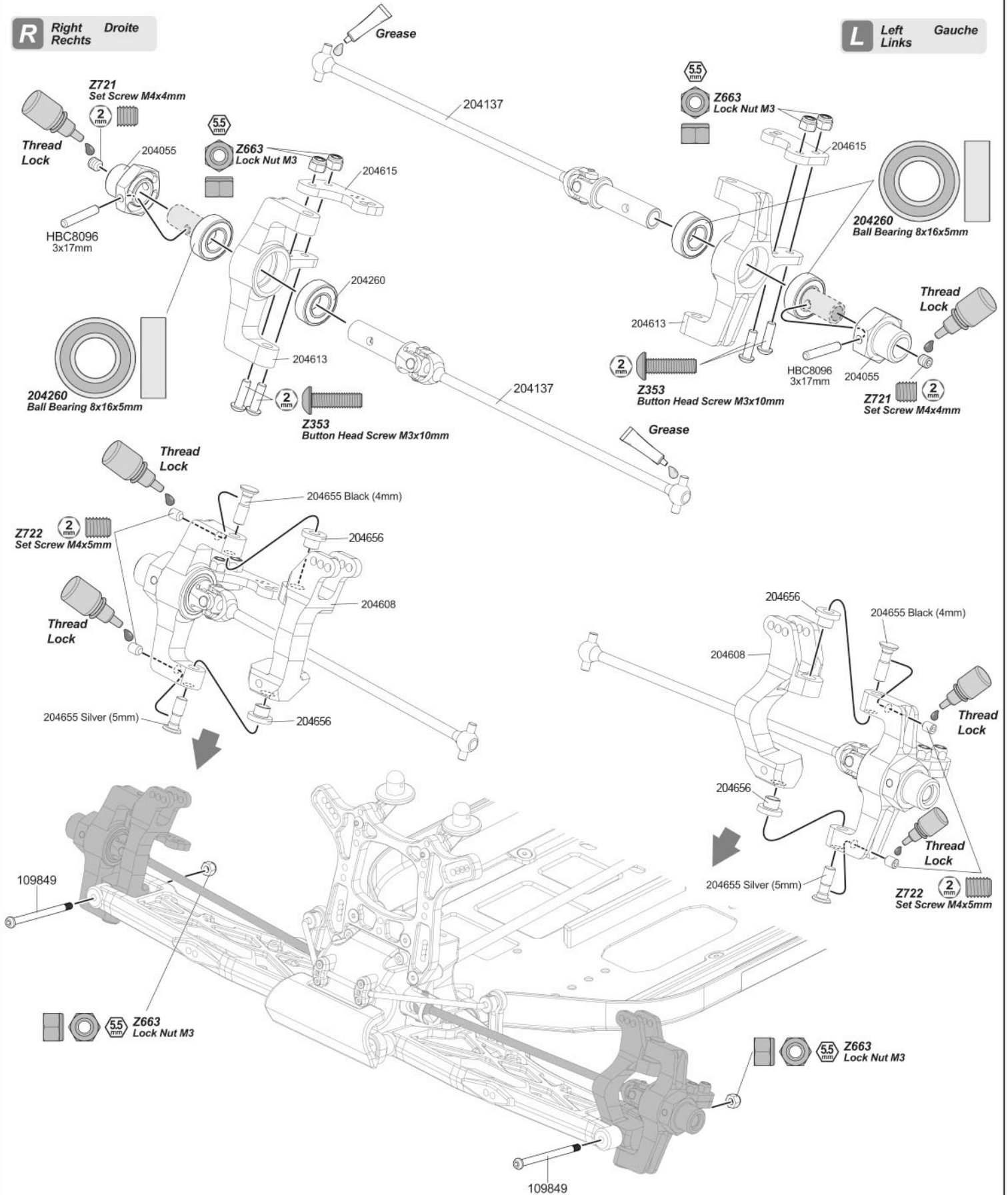

## STEP F-07-1

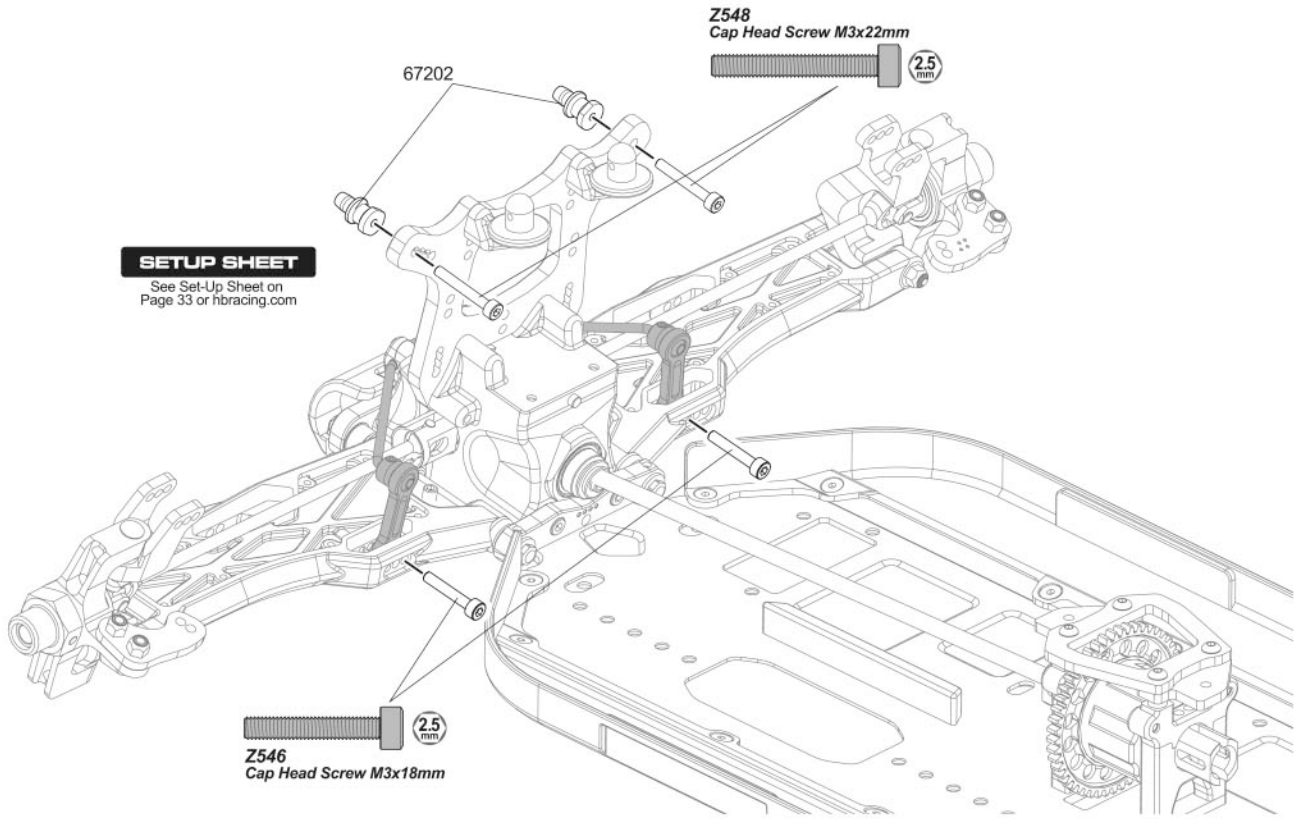

## STEP F-07-2

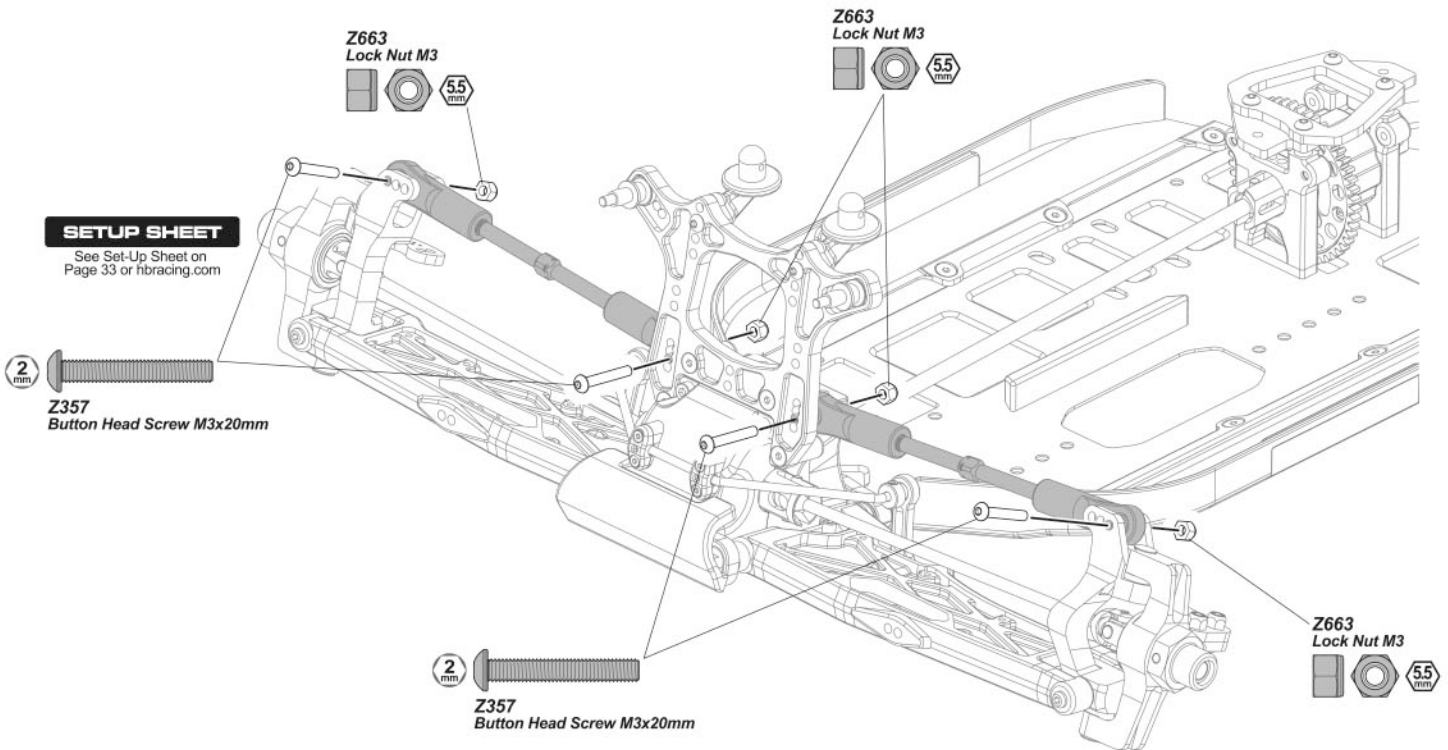



## STEP G-01

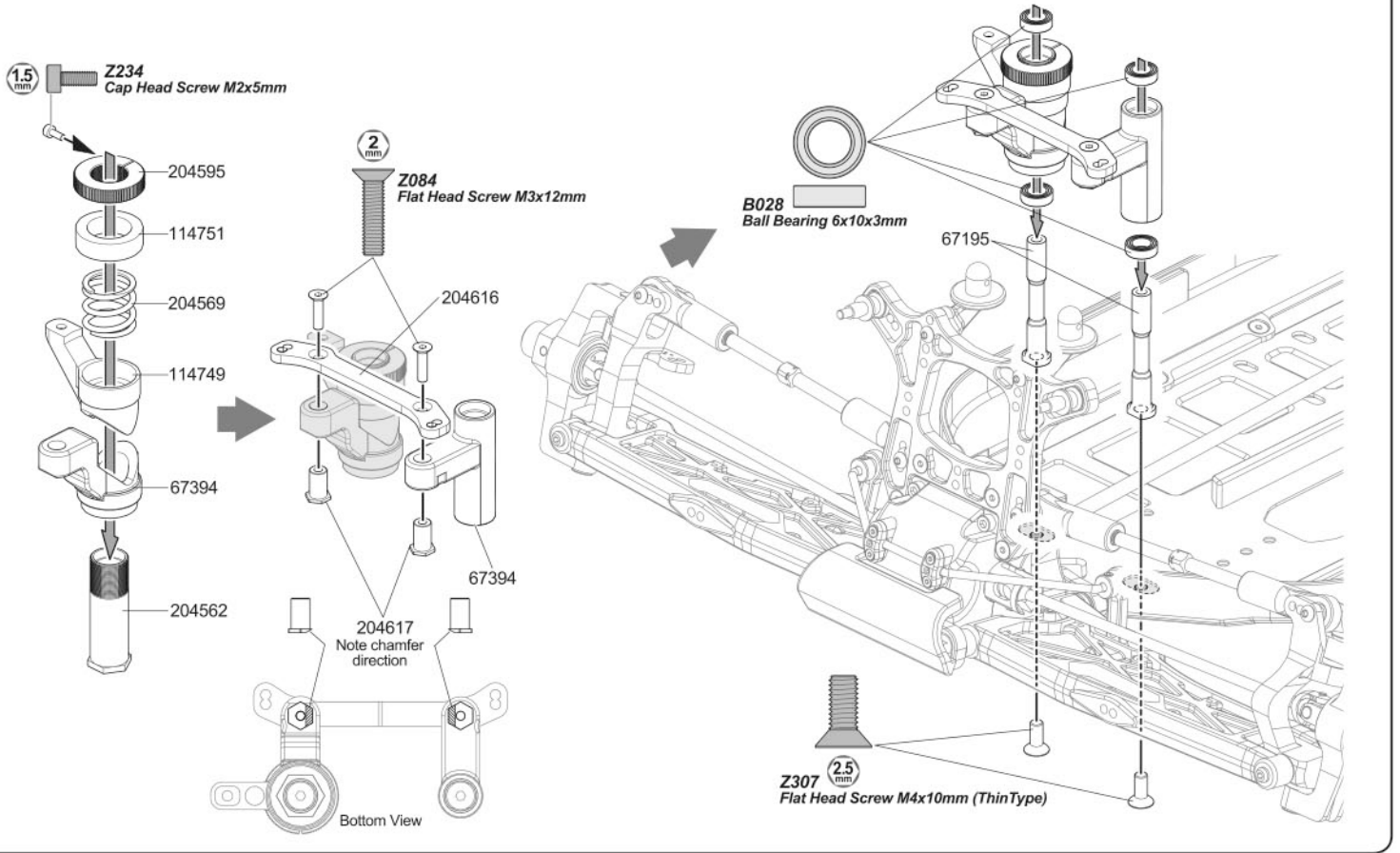

## STEP G-02

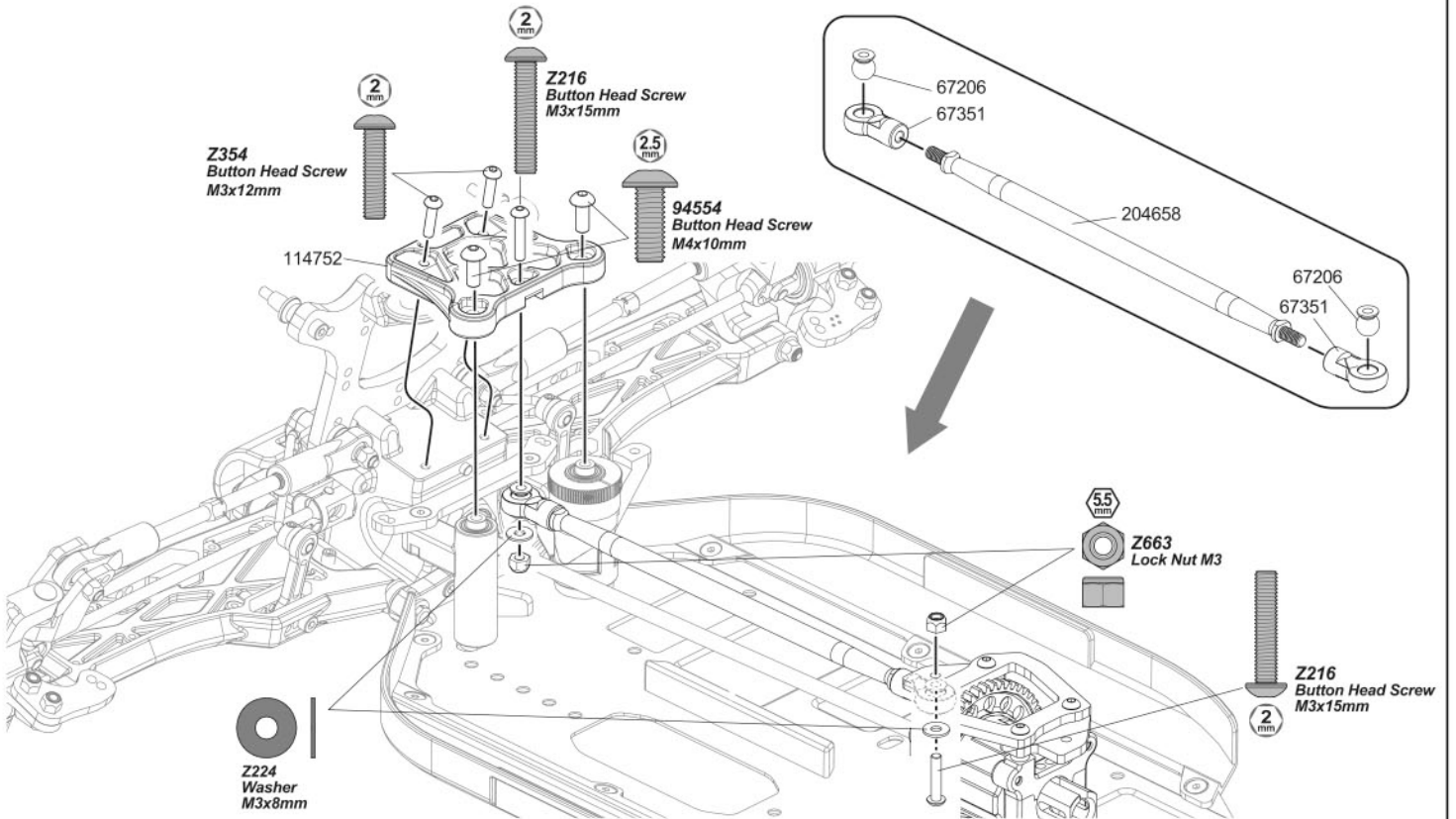

## STEP G-03

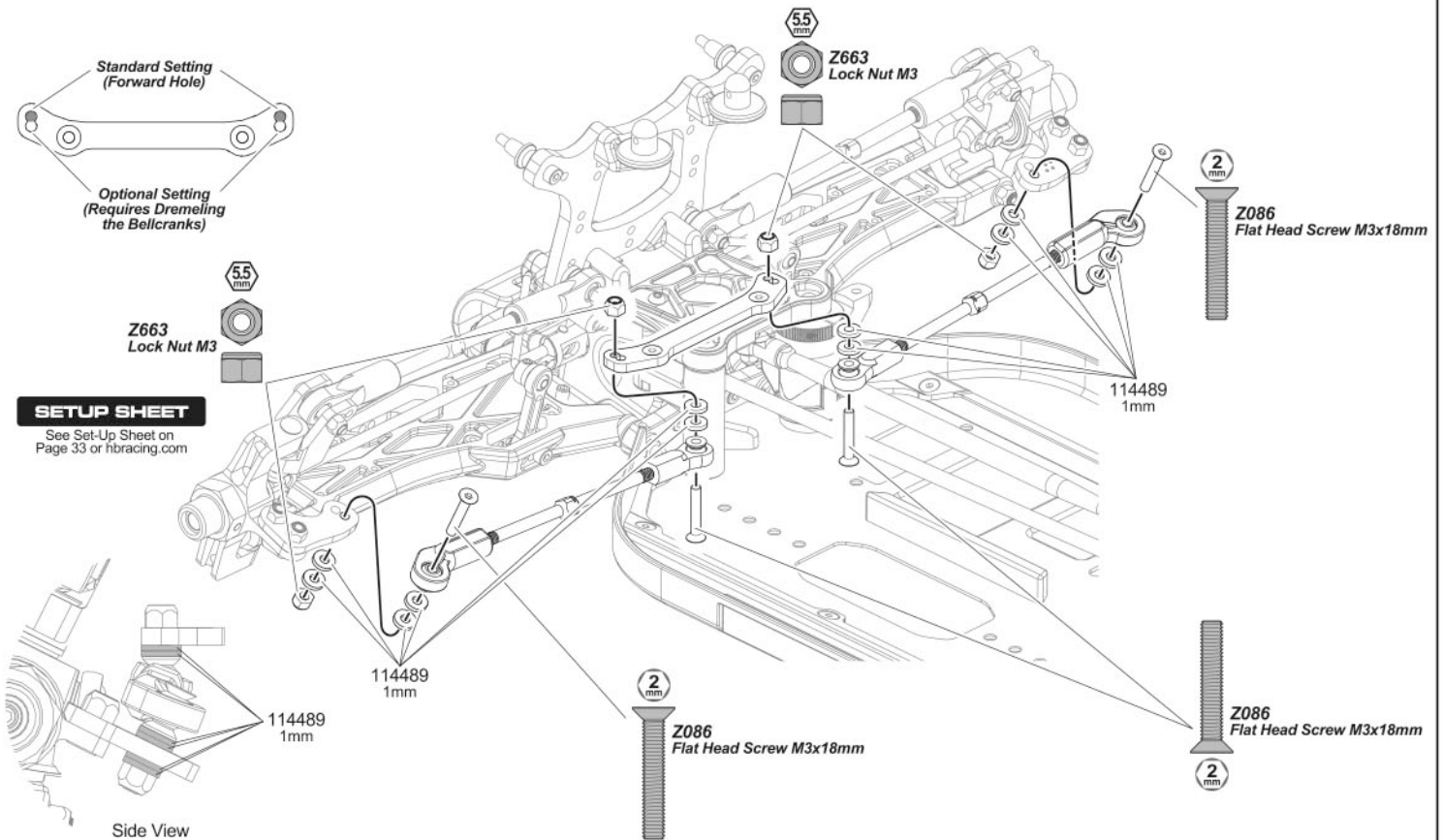

[www.HBRACING.com](http://www.HBRACING.com)

# HBT<sub>evo3</sub>

COMPETITION 1/8 SCALE 4WD ELECTRIC TRUGGY

# BAG-H

## STEP H-01

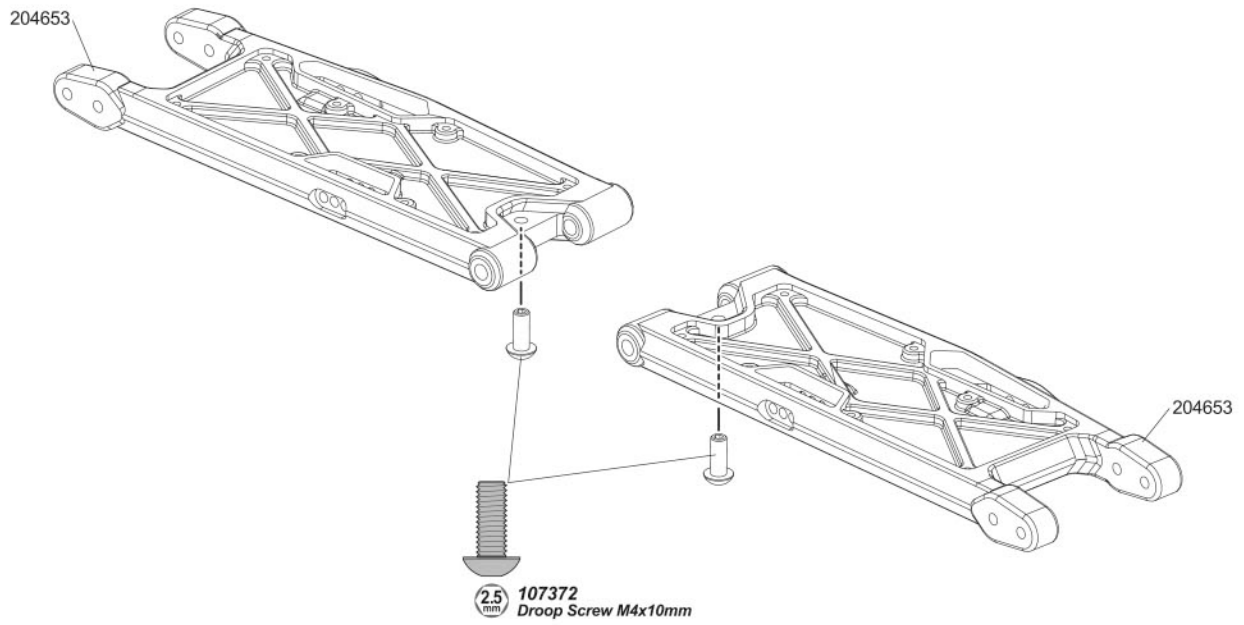

## STEP H-02

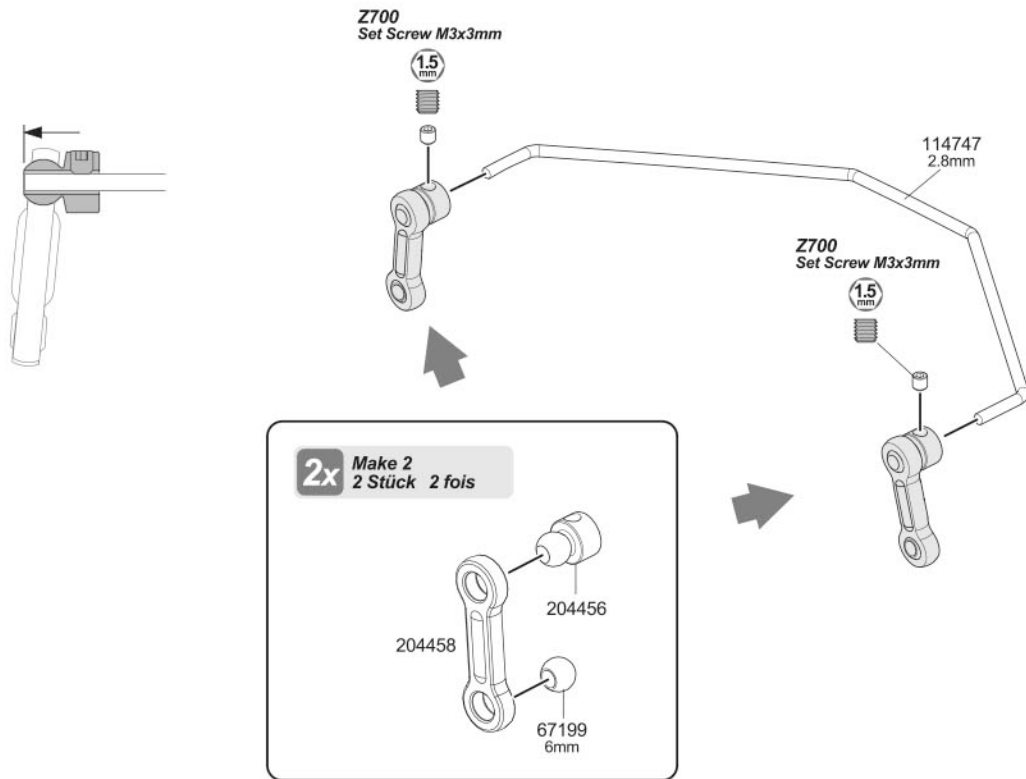

## STEP H-03

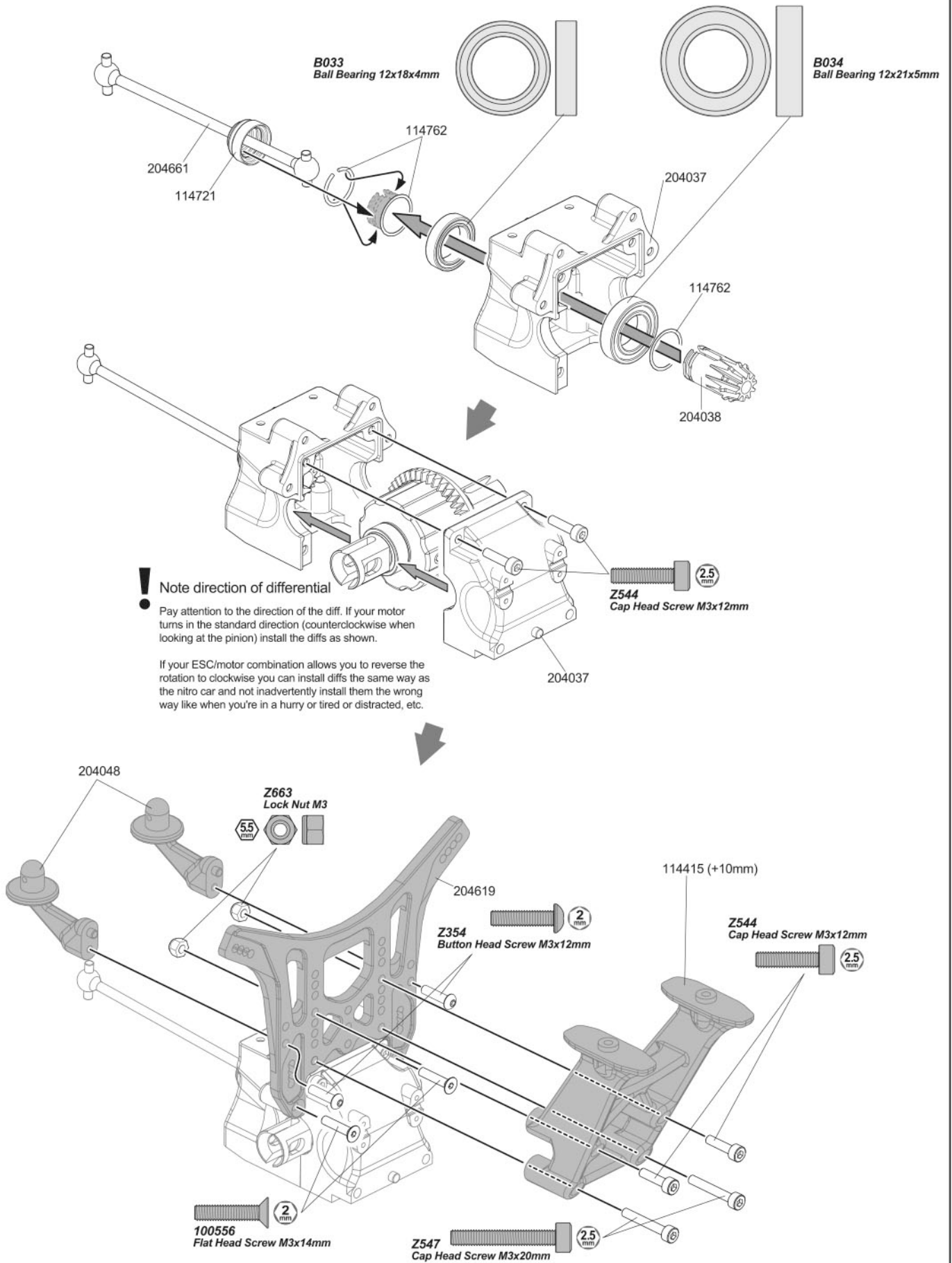

# BAG-H

## STEP H-04

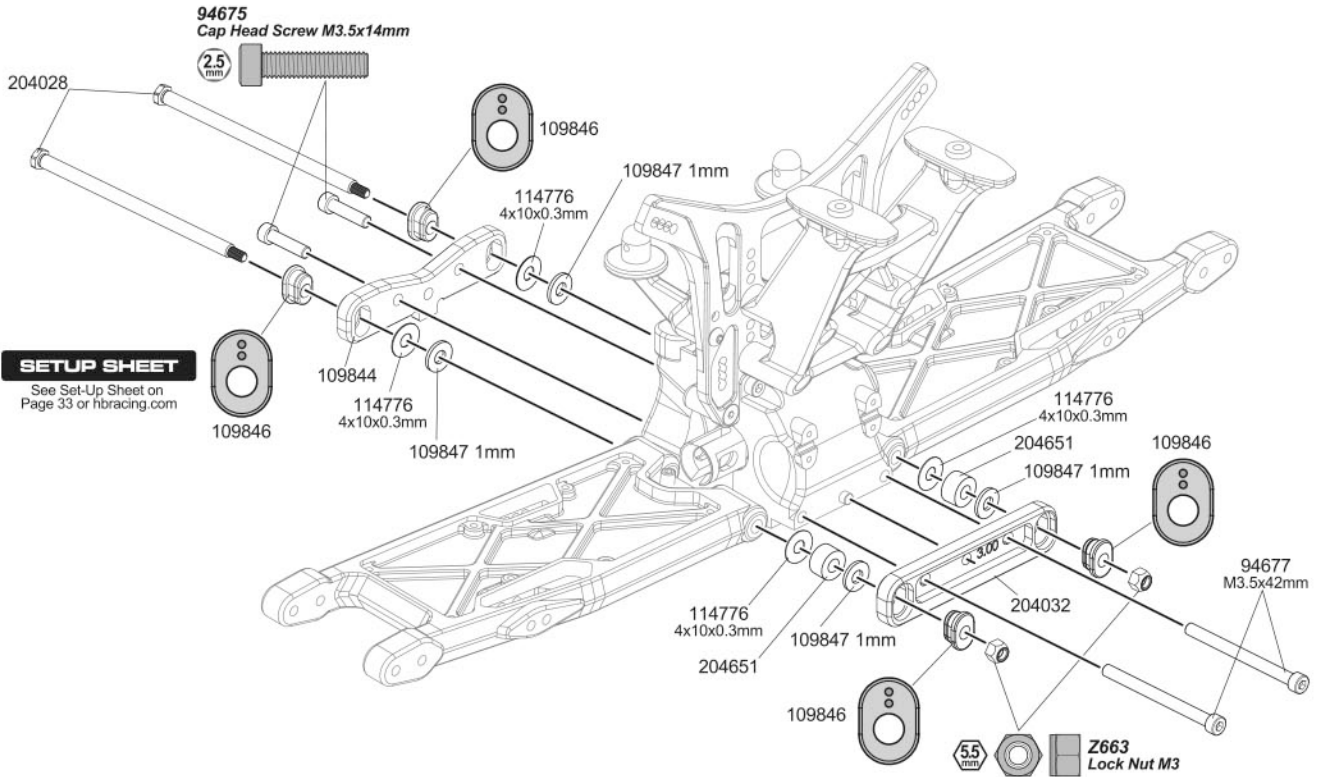

## STEP H-05-1

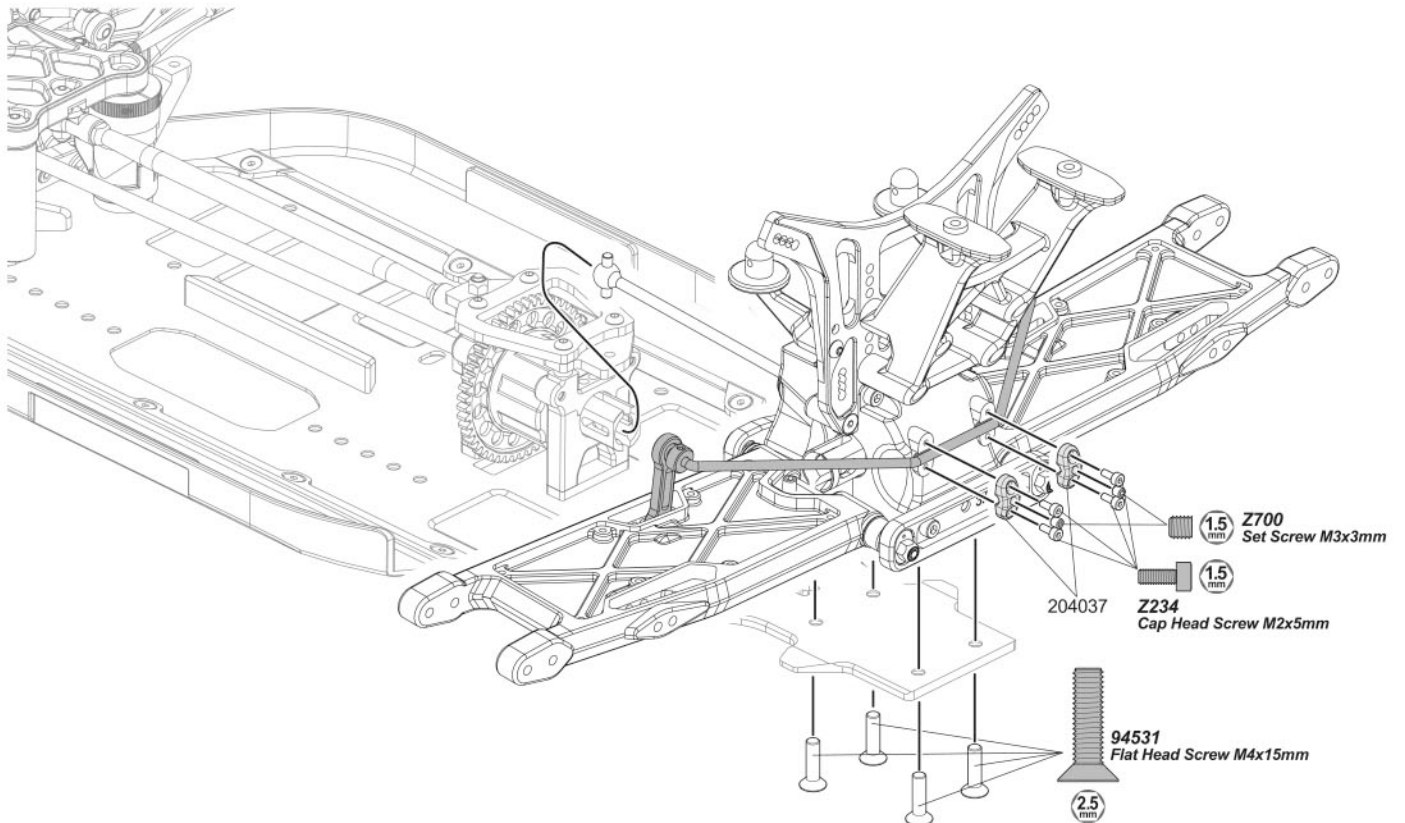

## STEP H-05-2

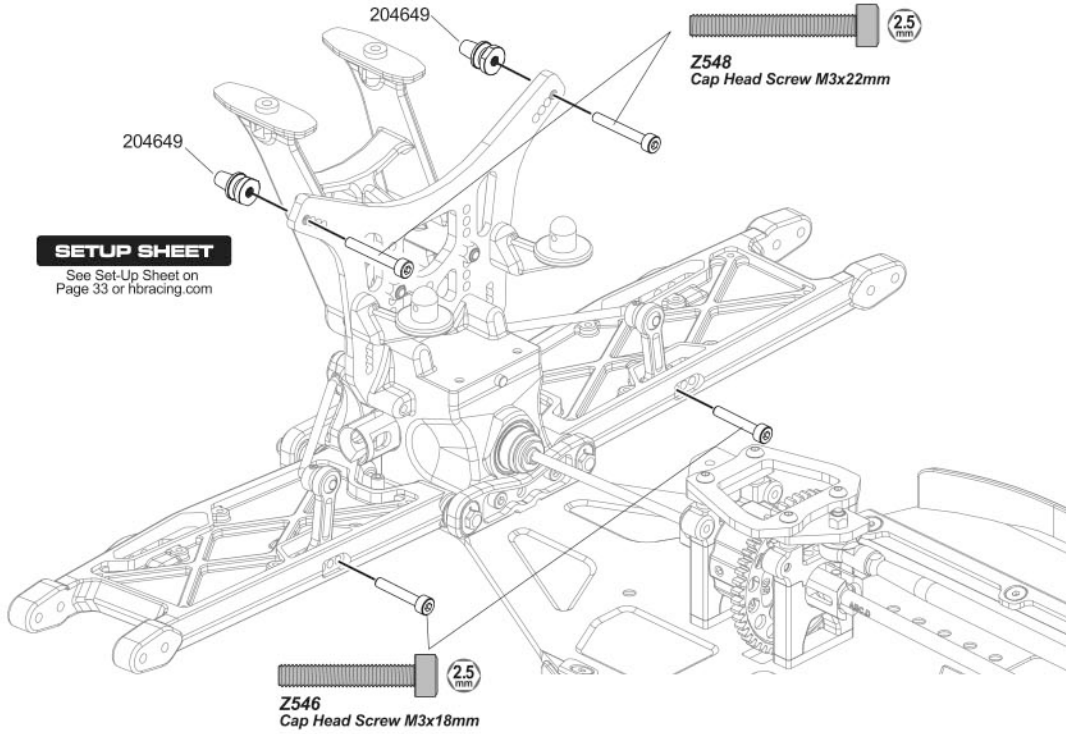

## STEP H-05-3

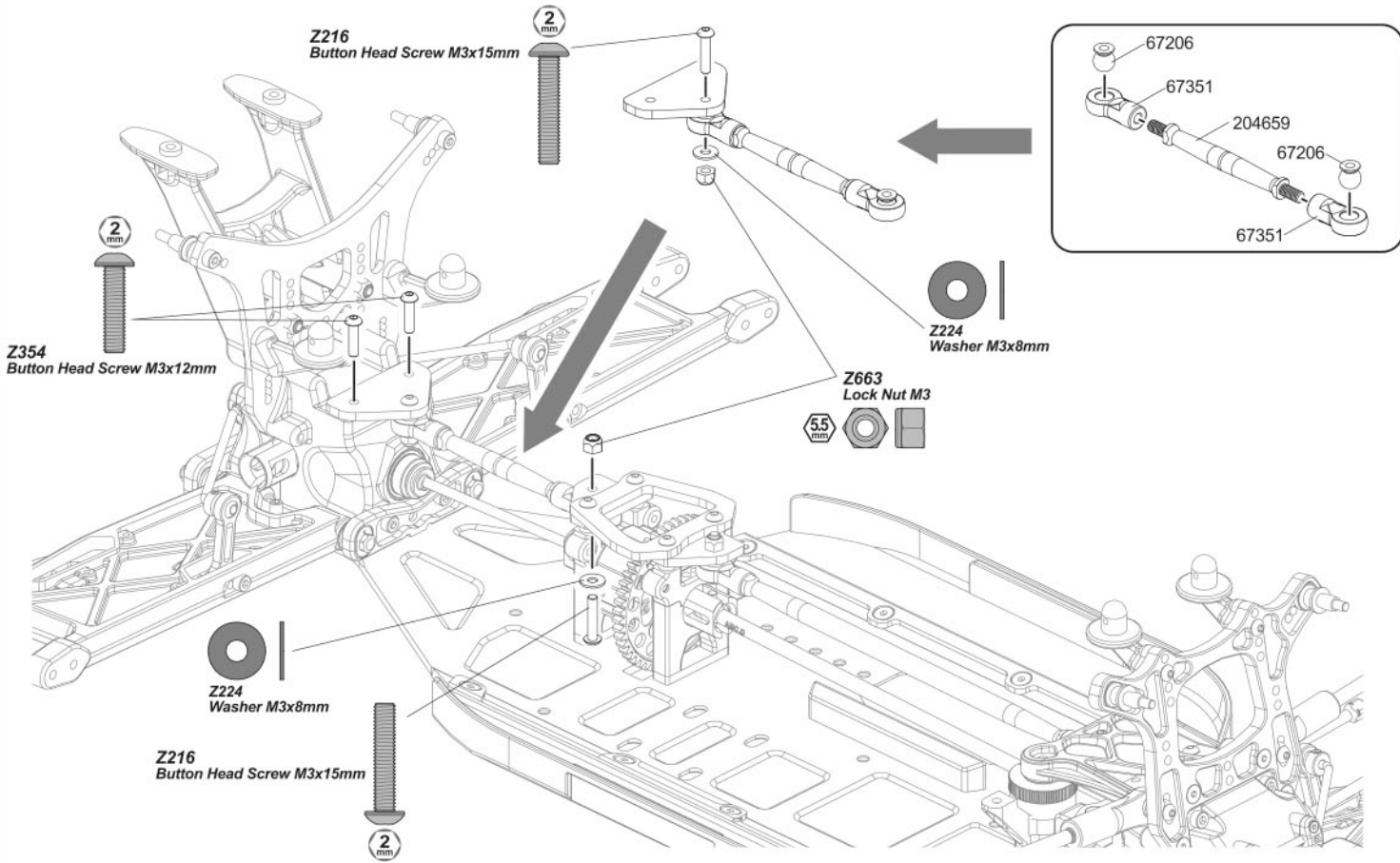

## STEP H-06

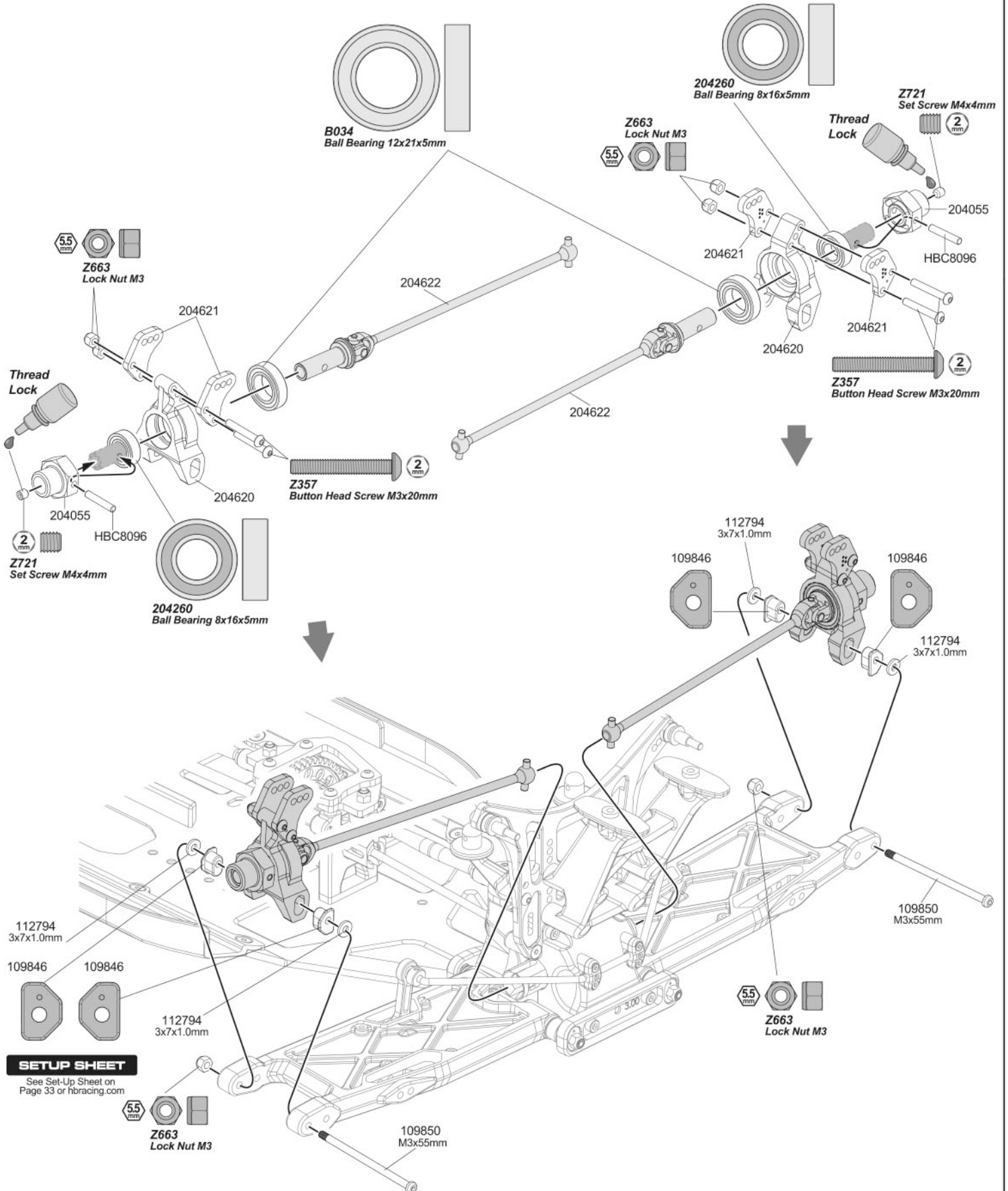

### SETUP SHEET

See Set-Up Sheet on Page 33 or hbracing.com



# BAG-H

## STEP H-07

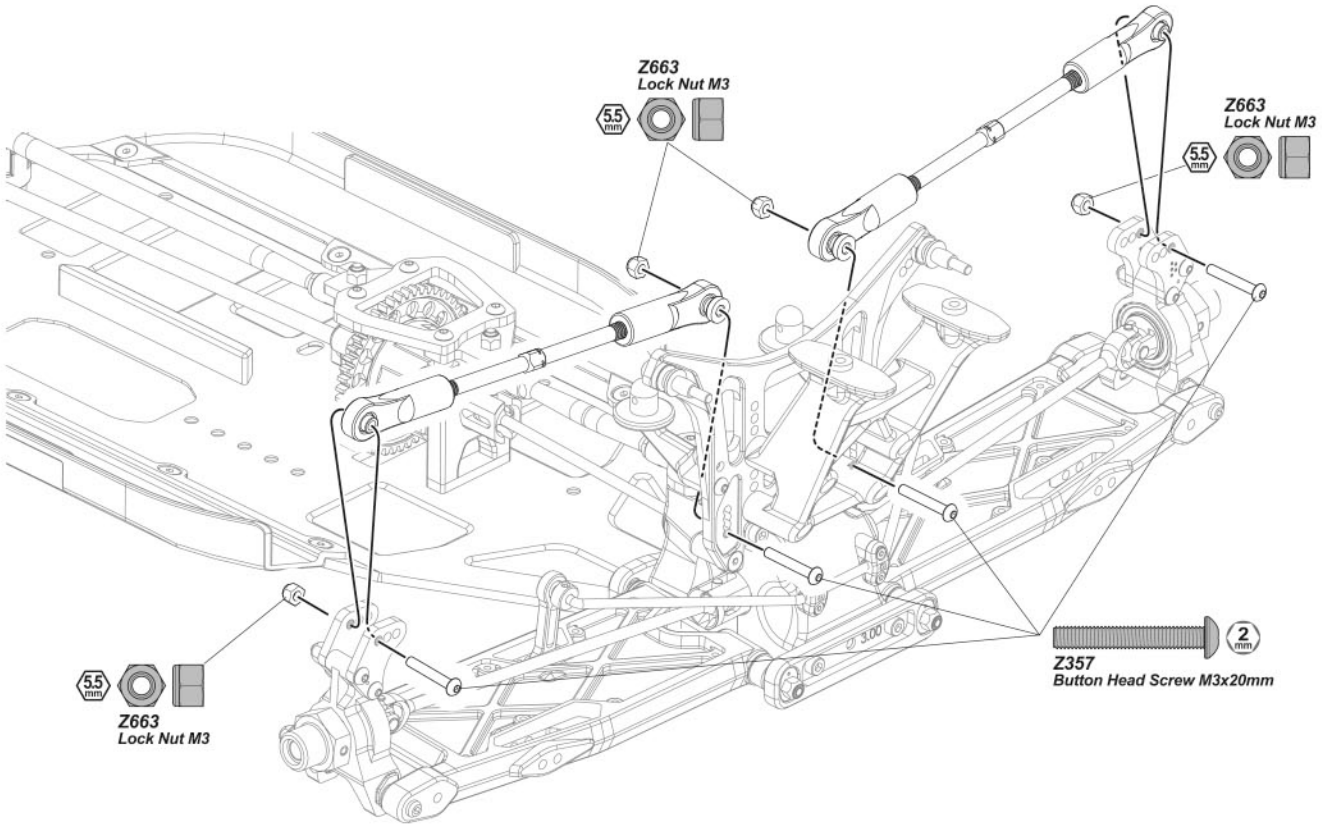

# BAG-I

## STEP I-01

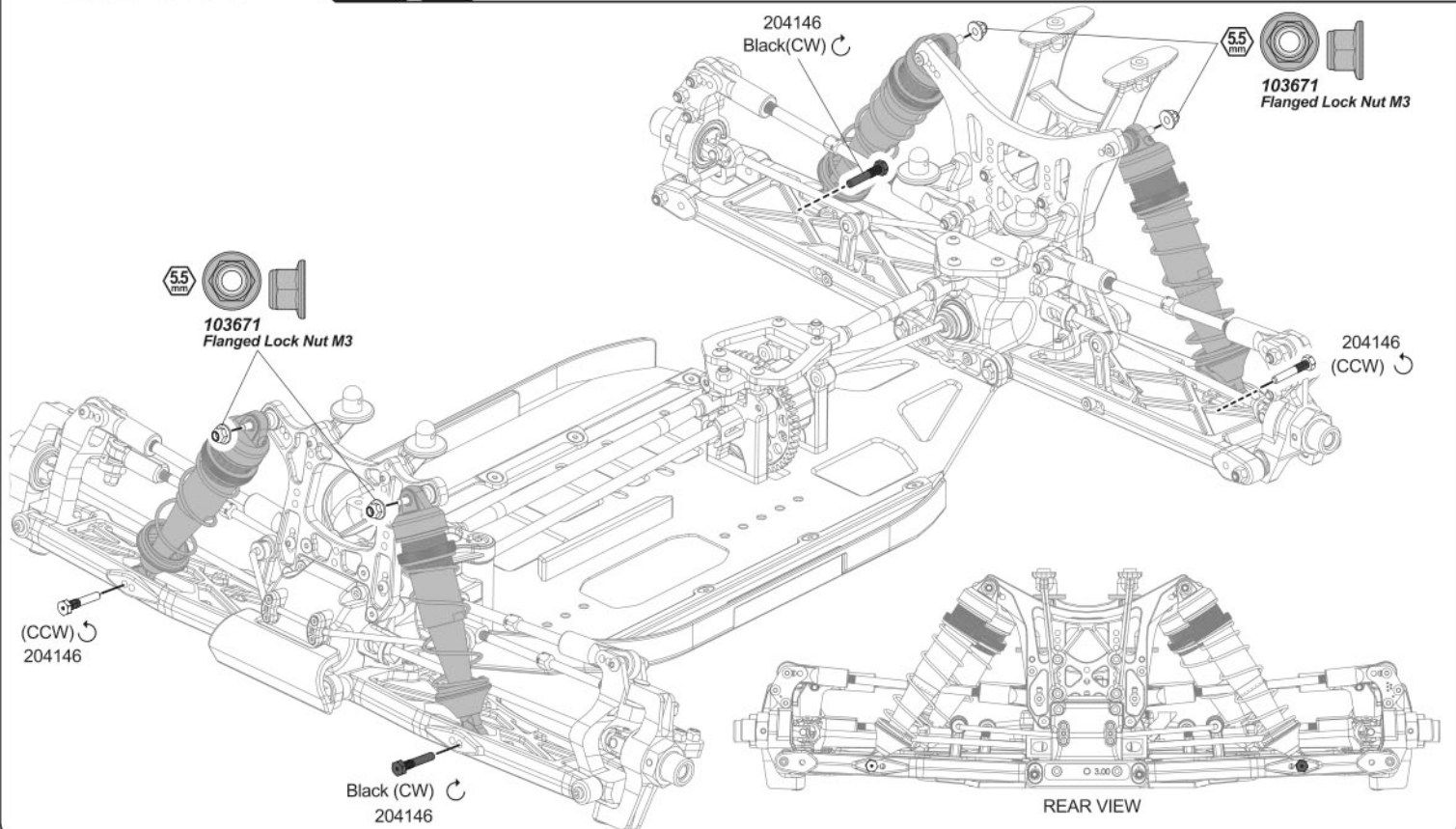



## STEP J-01

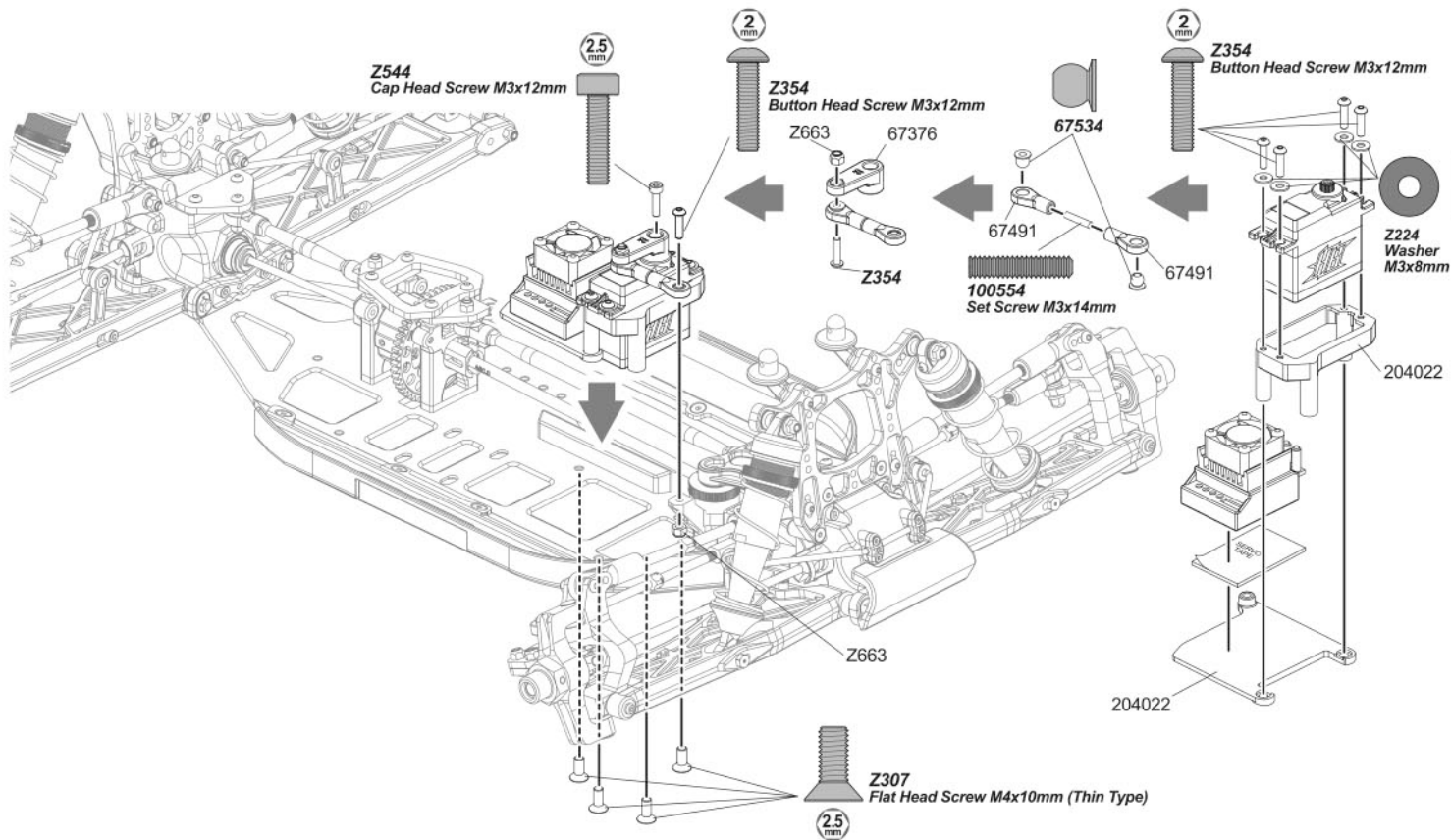

## STEP J-02

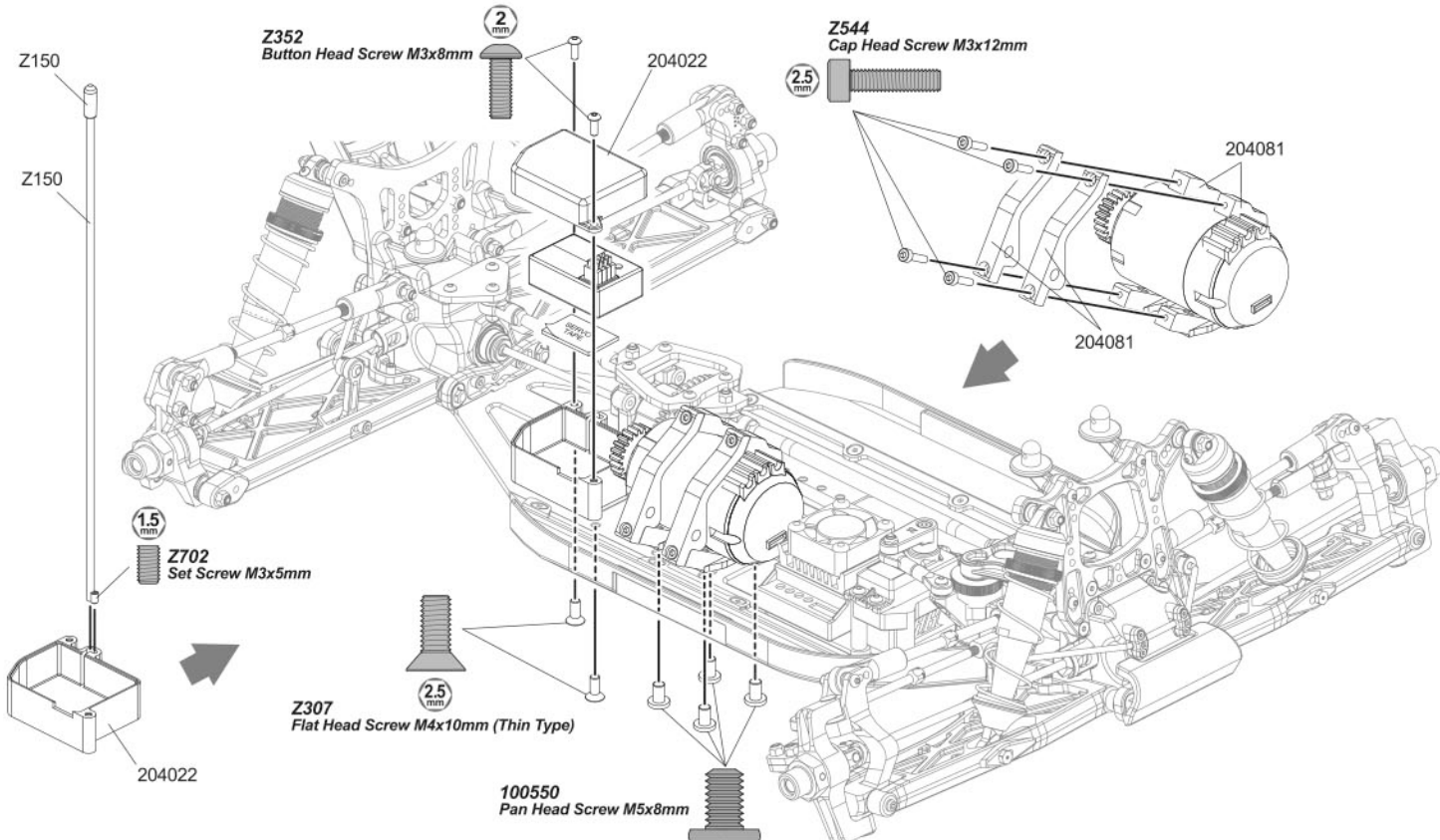

## STEP J-03

### BREAK-IN Z684 NUTS

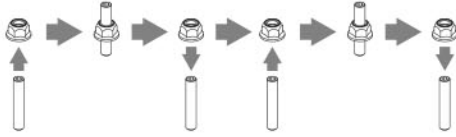

**Z684**  
Flanged Lock Nut M4

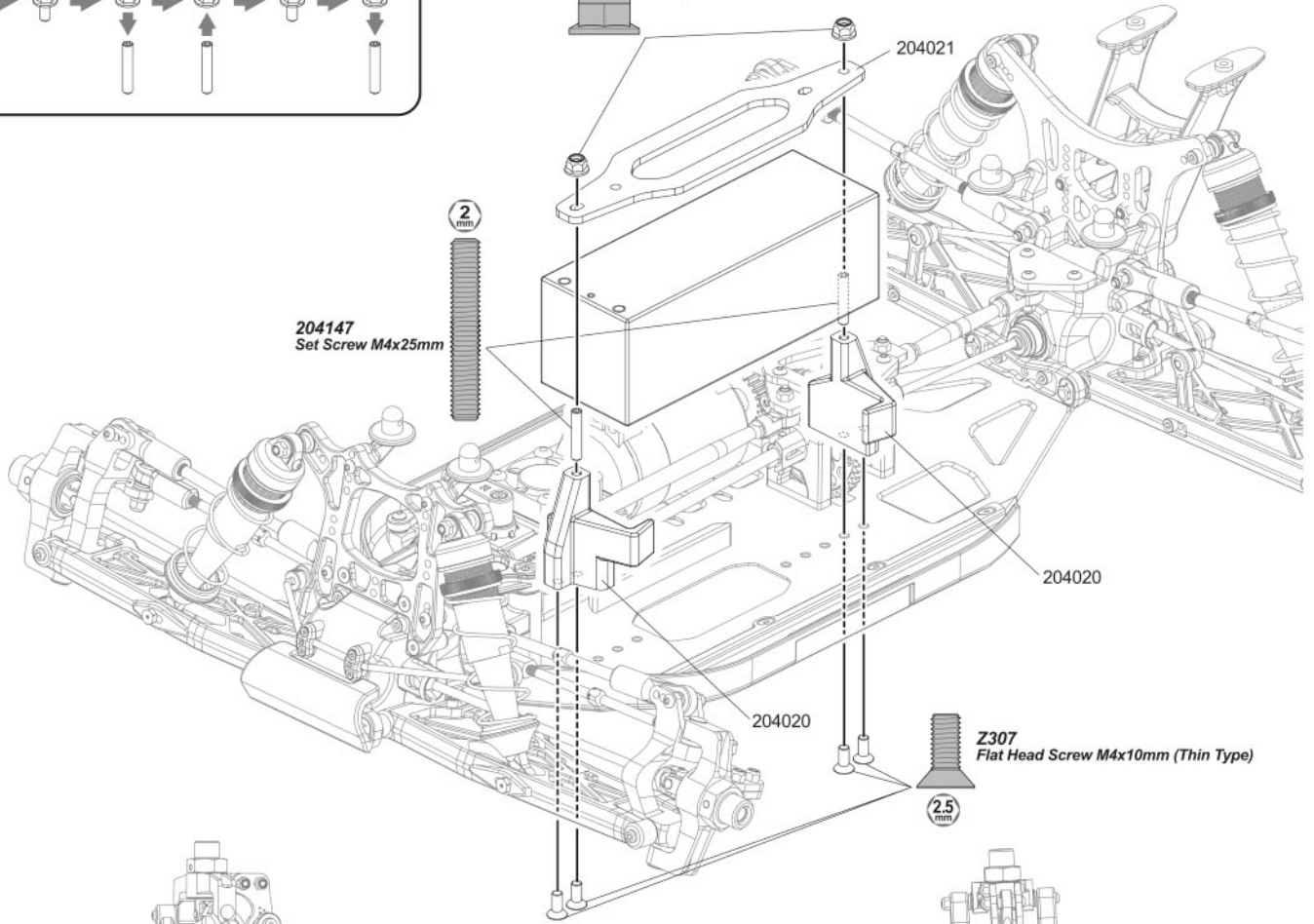

**204147**  
Set Screw M4x25mm

204021

204020

204020

**Z307**  
Flat Head Screw M4x10mm (Thin Type)

2.5 mm

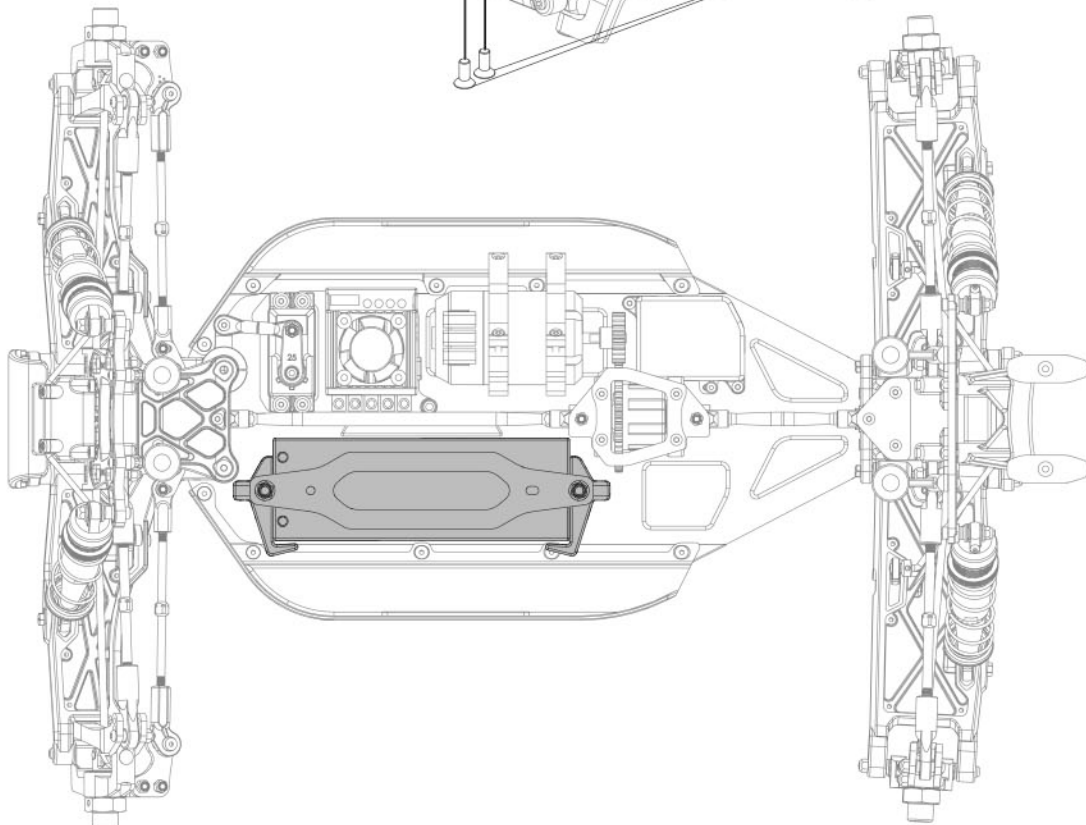

## STEP J-03

### ADJUSTABLE SHORTY BATTERY POSITION

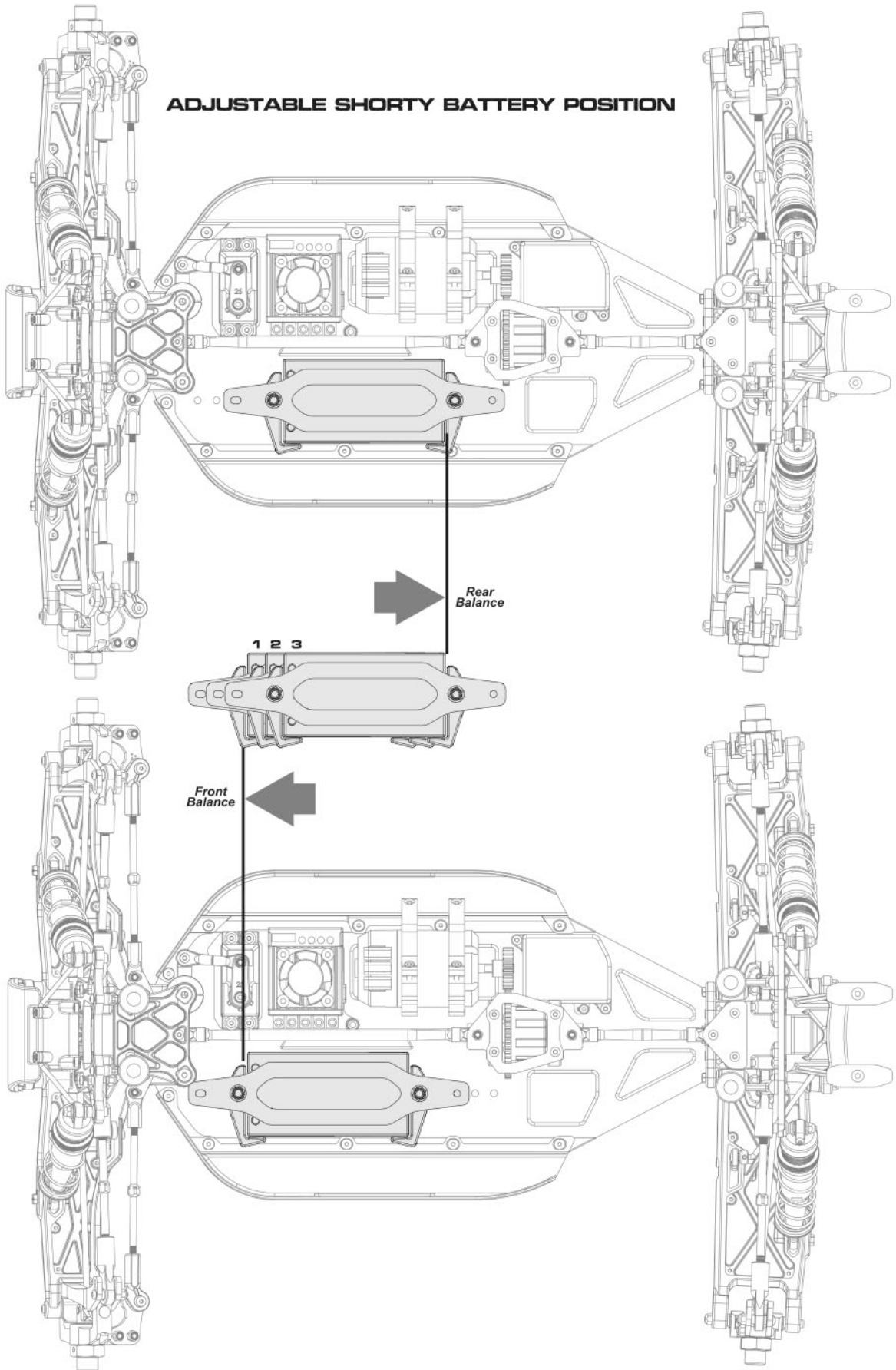

## STEP K-01

Paint inside of body with polycarbonate paint.  
Trim body with a hobby knife or curved scissors.  
Use a reamer for body mount holes.  
Remove outer protective film before applying stickers.

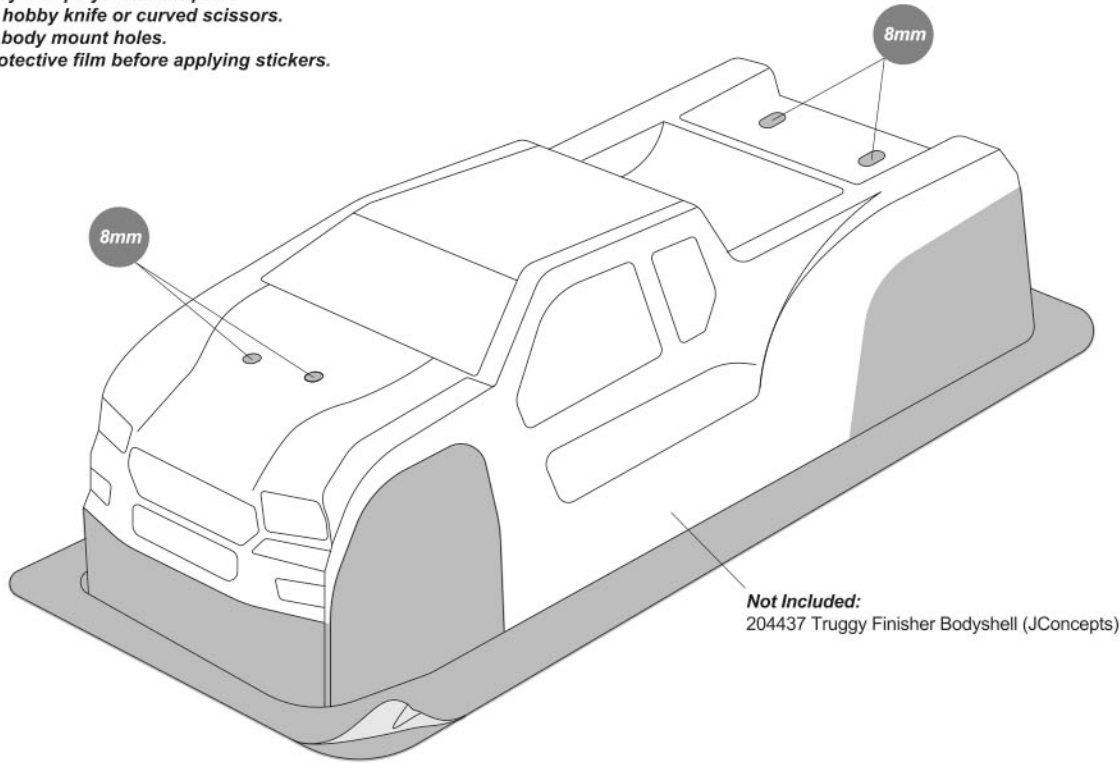

## STEP K-02

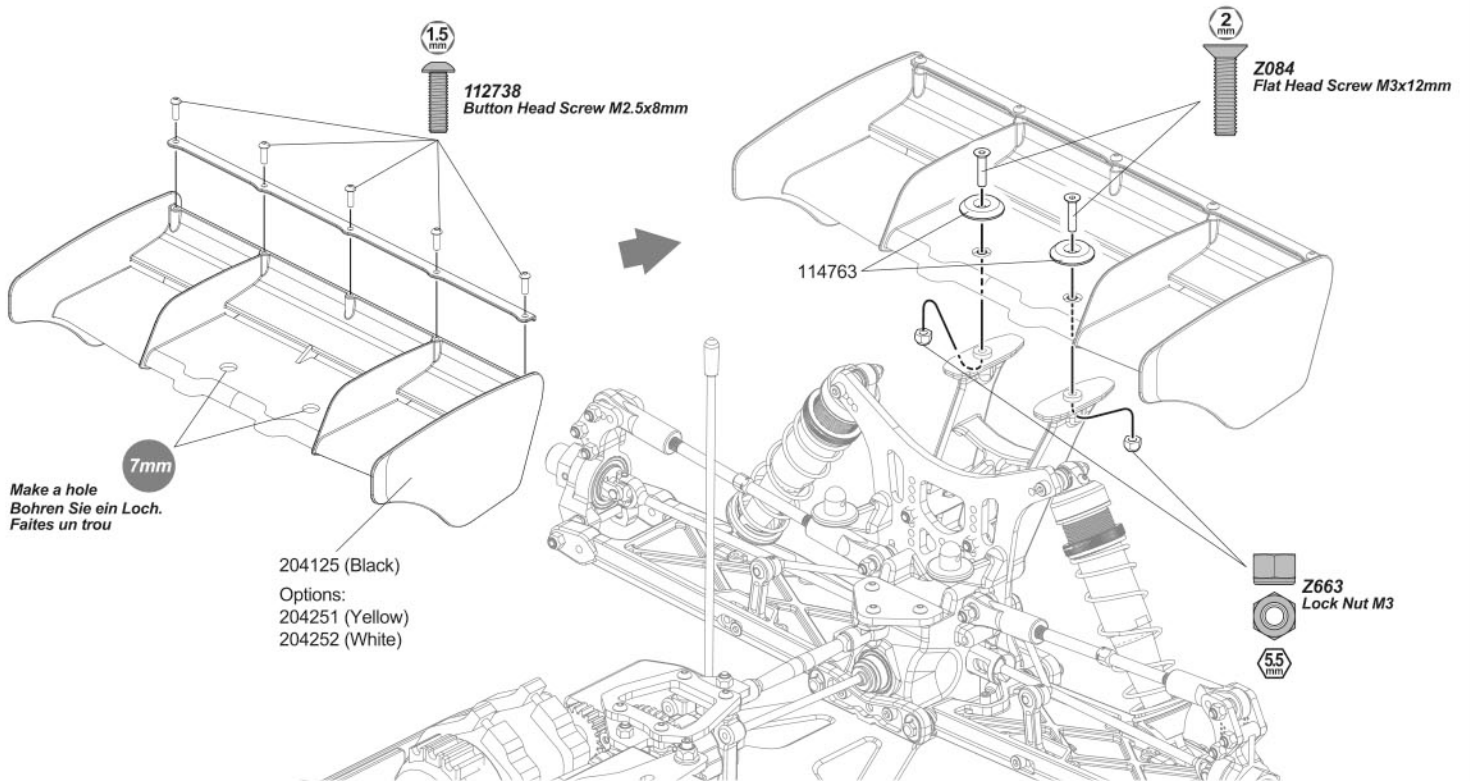

## STEP K-03

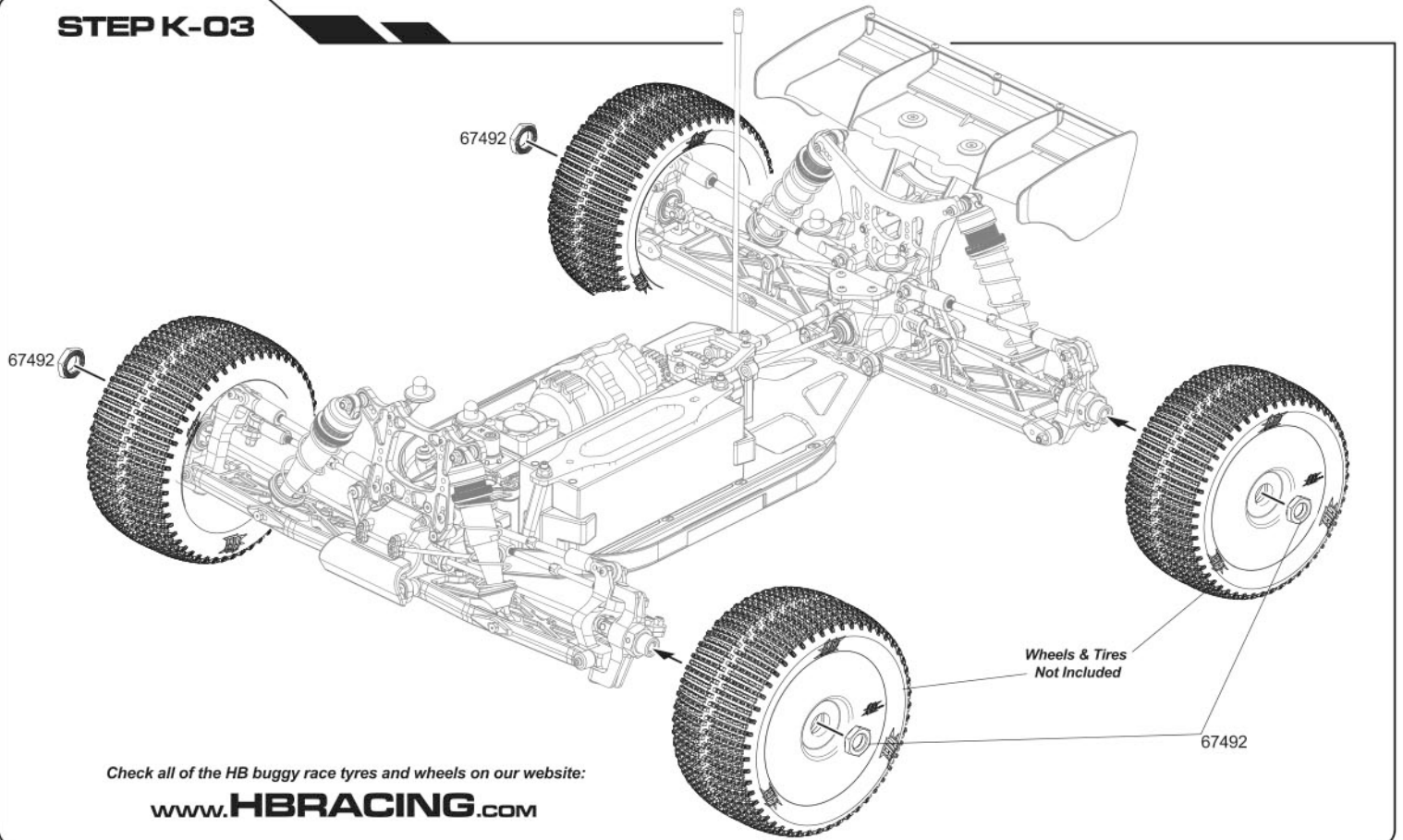

## STEP K-04

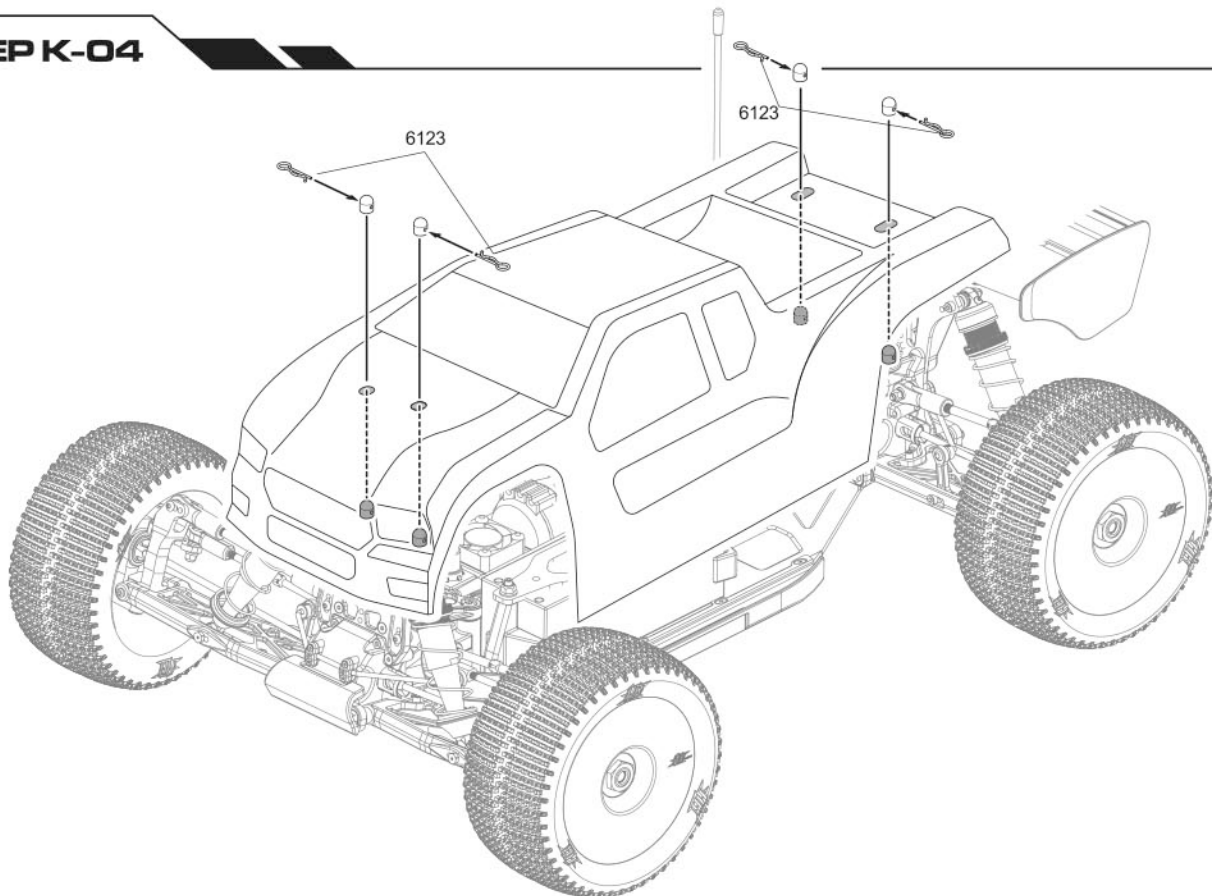

# EXPLODED VIEW

## UPDATES

Check [www.hbracing.com](http://www.hbracing.com) for the latest updates to the instructions.

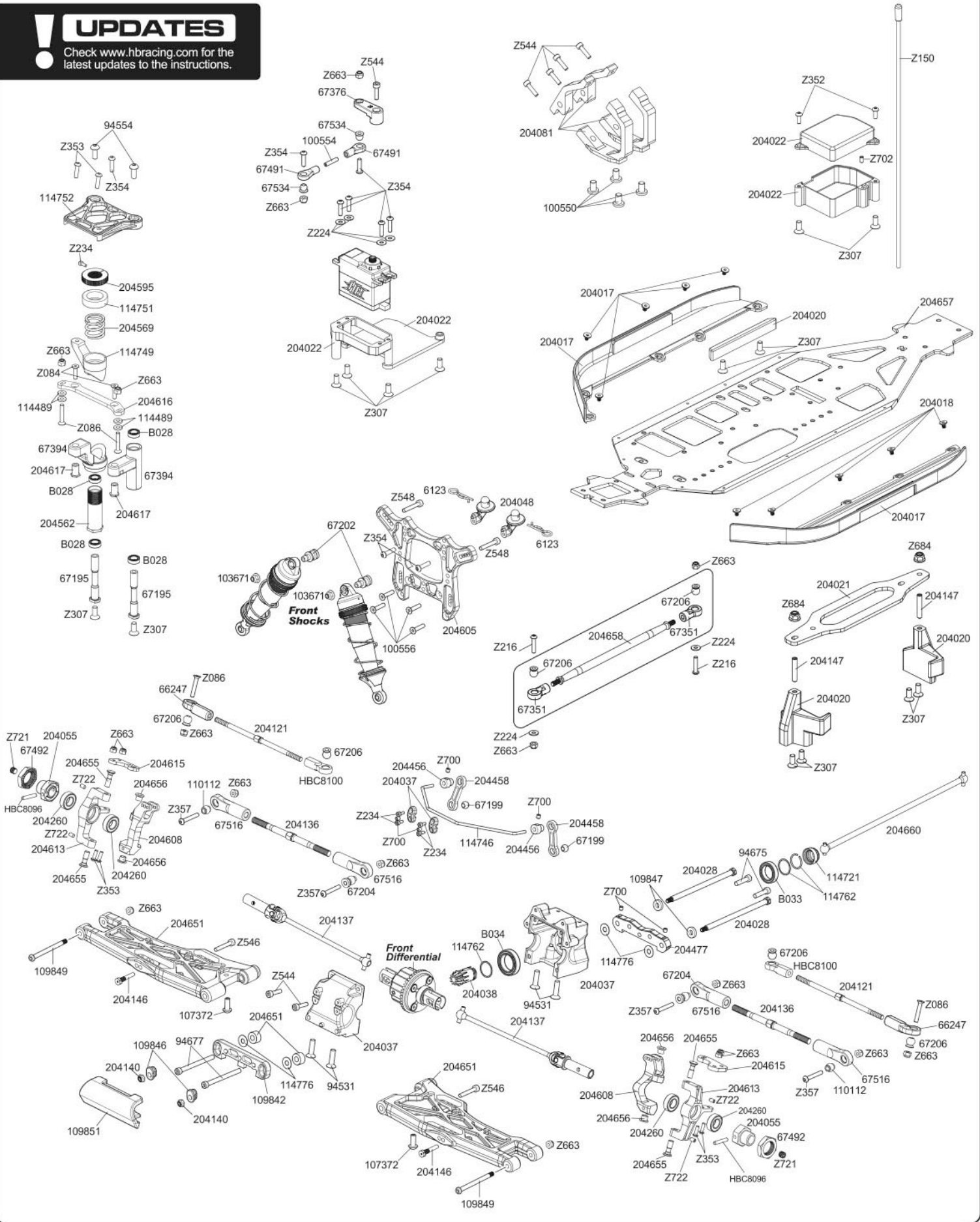

# EXPLODED VIEW

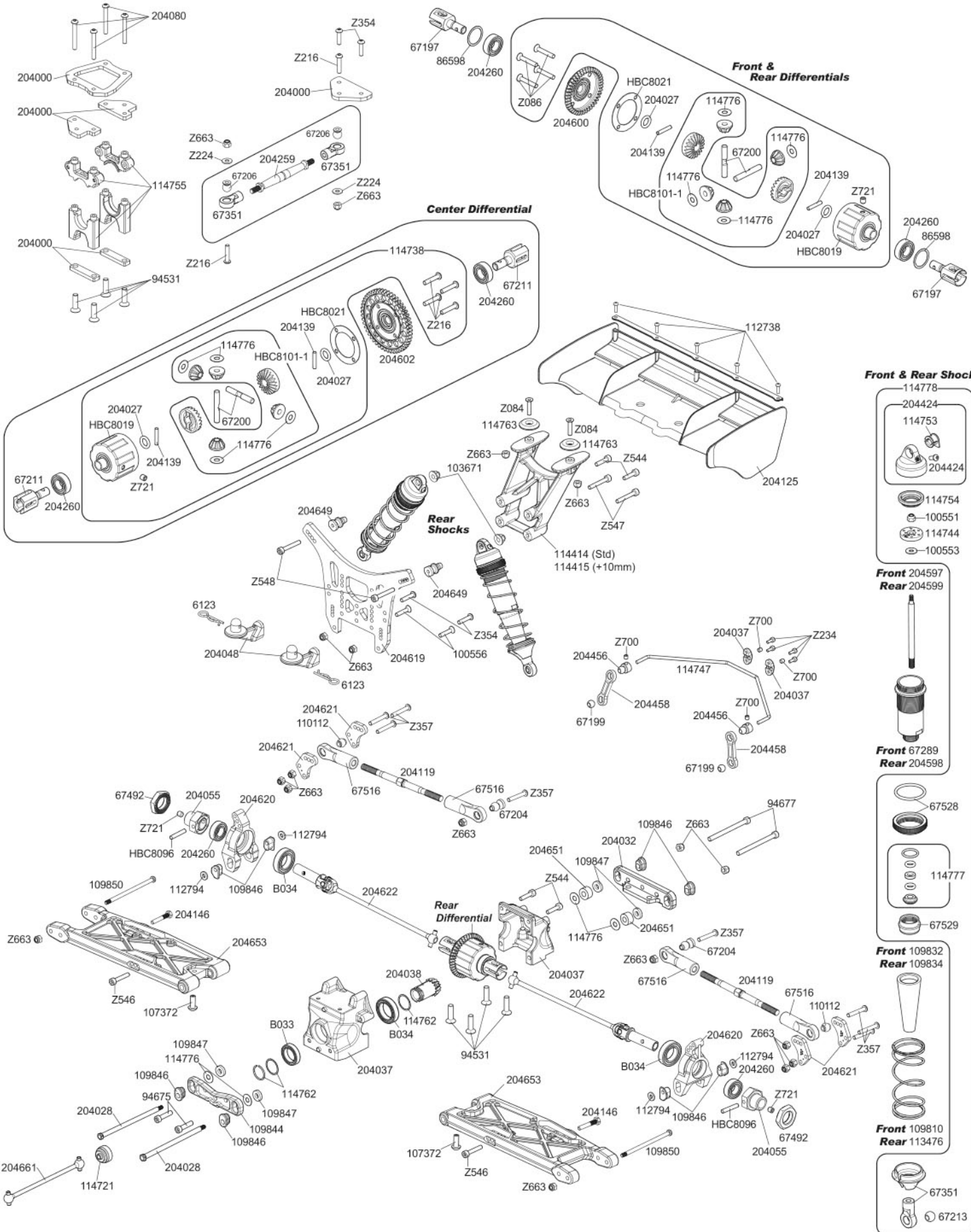

Driver \_\_\_\_\_ Date \_\_\_\_\_ Track \_\_\_\_\_ Event \_\_\_\_\_

Track Condition \_\_\_\_\_

Temperature \_\_\_\_\_

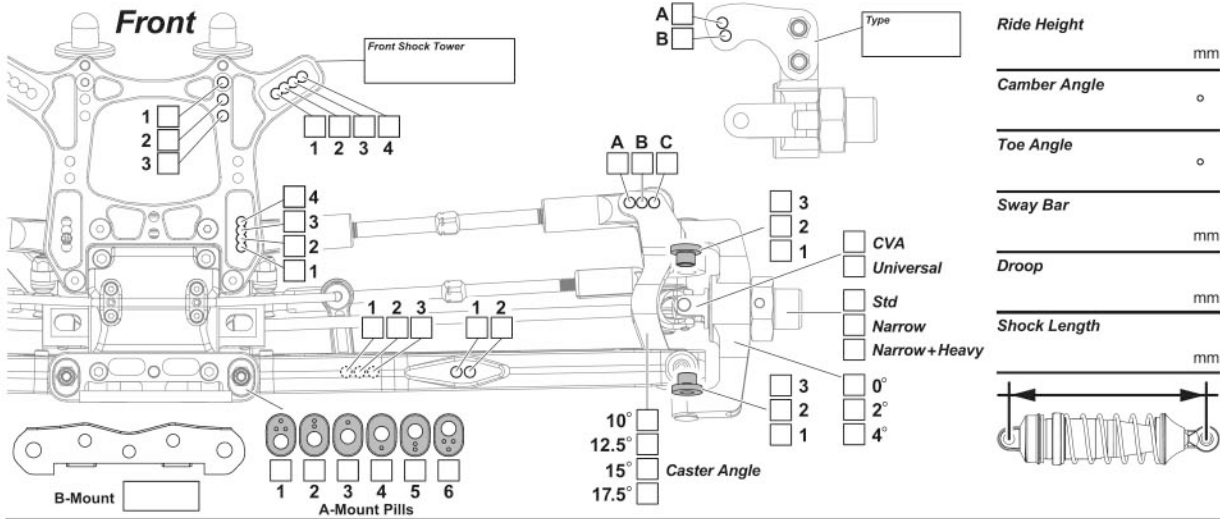

### Front Shocks

Oil weight \_\_\_\_\_ wt

Piston \_\_\_\_\_ mm

Bladder \_\_\_\_\_ mm

Spring \_\_\_\_\_ mm

Ride Height \_\_\_\_\_ mm

Camber Angle \_\_\_\_\_ °

Toe Angle \_\_\_\_\_ °

Sway Bar \_\_\_\_\_ mm

Droop \_\_\_\_\_ mm

Shock Length \_\_\_\_\_ mm

Notes \_\_\_\_\_

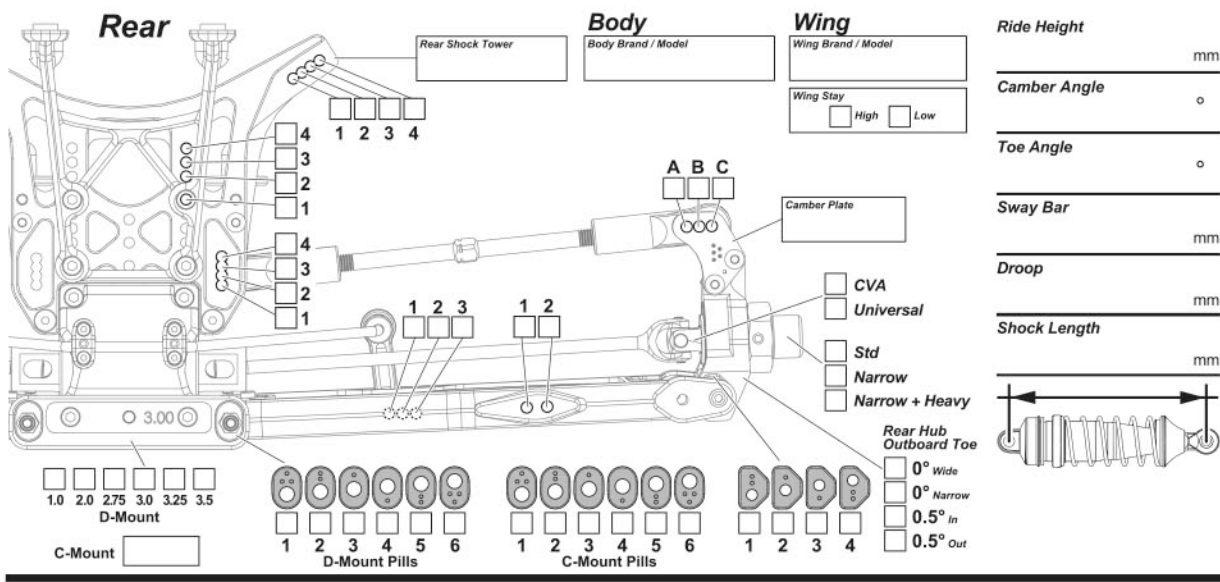

### Rear Shocks

Oil weight \_\_\_\_\_ wt

Piston \_\_\_\_\_ mm

Bladder \_\_\_\_\_ mm

Spring \_\_\_\_\_ mm

Ride Height \_\_\_\_\_ mm

Camber Angle \_\_\_\_\_ °

Toe Angle \_\_\_\_\_ °

Sway Bar \_\_\_\_\_ mm

Droop \_\_\_\_\_ mm

Shock Length \_\_\_\_\_ mm

Notes \_\_\_\_\_

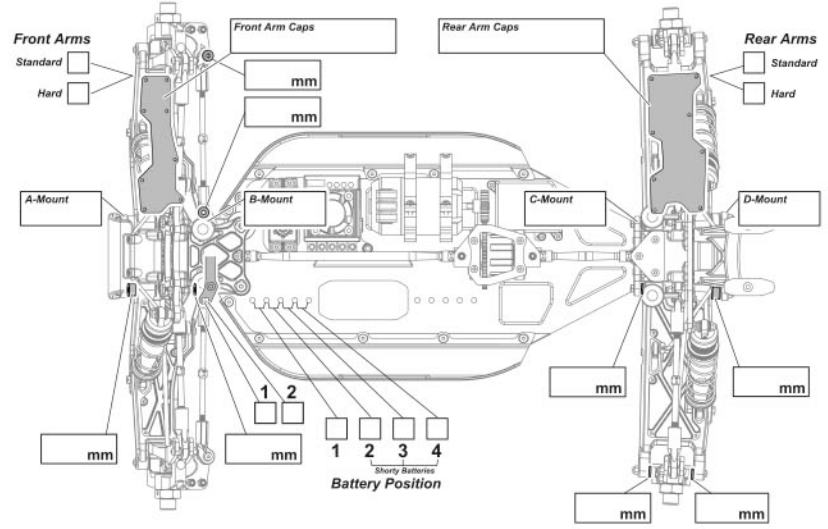

### Motor

Brand / Model \_\_\_\_\_

Spur gear \_\_\_\_\_ Pinion Gear \_\_\_\_\_

### Tires

	Front	Rear
Brand	_____	_____
Compound	_____	_____
Insert	_____	_____
Wheel	_____	_____
Notes	_____	_____

### Battery

Brand / Model \_\_\_\_\_

### ESC

Brand / Model \_\_\_\_\_

### Diff Oils

	Front	Center	Rear
Brand	_____	_____	_____
Oil	_____	_____	_____

Notes \_\_\_\_\_



Driver \_\_\_\_\_ Date \_\_\_\_\_ Track \_\_\_\_\_ Event \_\_\_\_\_

Track Condition \_\_\_\_\_

Temperature \_\_\_\_\_

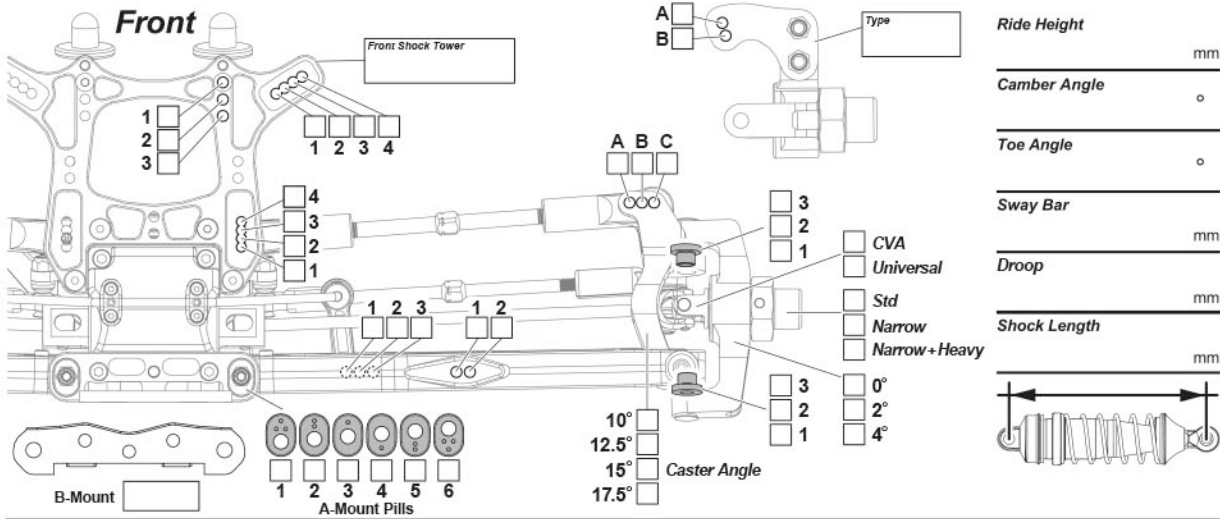

Ride Height \_\_\_\_\_ mm

Camber Angle \_\_\_\_\_ °

Toe Angle \_\_\_\_\_ °

Sway Bar \_\_\_\_\_ mm

Droop \_\_\_\_\_ mm

Shock Length \_\_\_\_\_ mm

### Front Shocks

Oil weight \_\_\_\_\_ wt

Piston \_\_\_\_\_ mm

Bladder \_\_\_\_\_ mm

Spring \_\_\_\_\_ mm

Notes \_\_\_\_\_

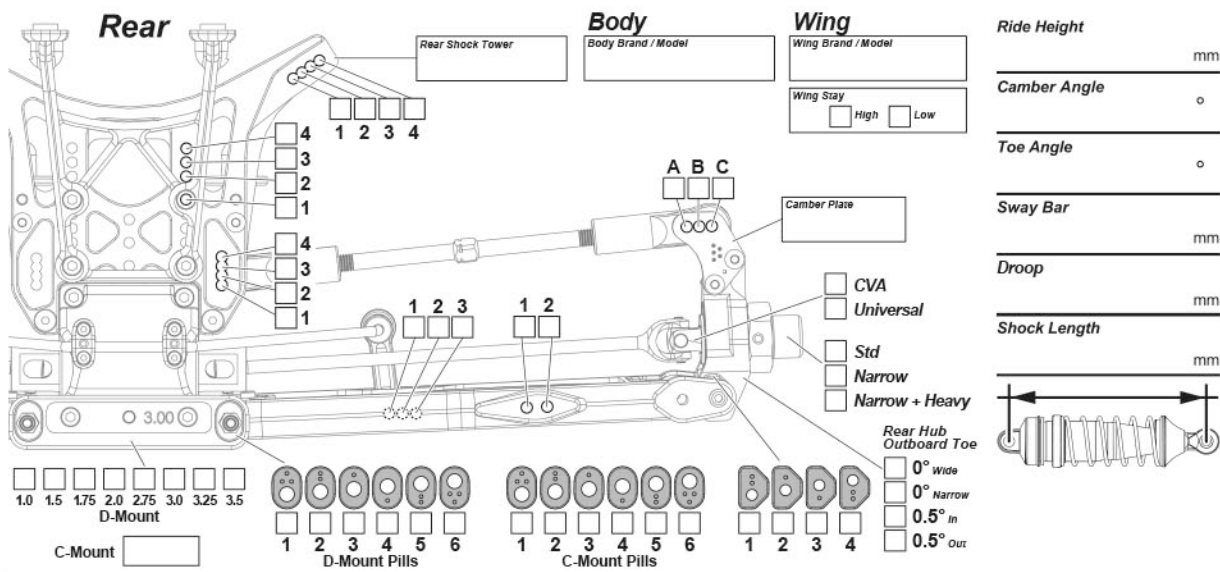

Ride Height \_\_\_\_\_ mm

Camber Angle \_\_\_\_\_ °

Toe Angle \_\_\_\_\_ °

Sway Bar \_\_\_\_\_ mm

Droop \_\_\_\_\_ mm

Shock Length \_\_\_\_\_ mm

### Rear Shocks

Oil weight \_\_\_\_\_ wt

Piston \_\_\_\_\_ mm

Bladder \_\_\_\_\_ mm

Spring \_\_\_\_\_ mm

Notes \_\_\_\_\_

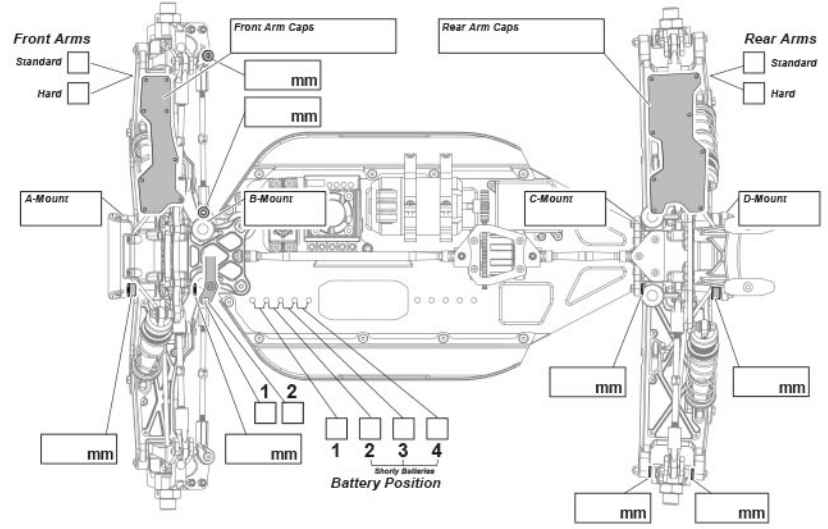

### Motor

Brand / Model \_\_\_\_\_

Spur gear \_\_\_\_\_ Pinion Gear \_\_\_\_\_

### Battery

Brand / Model \_\_\_\_\_

### ESC

Brand / Model \_\_\_\_\_

Diff Oils	Front	Center	Rear
Brand	_____	_____	_____
Oil	_____	_____	_____

Tires	Front	Rear
Brand	_____	_____
Compound	_____	_____
Insert	_____	_____
Wheel	_____	_____
Notes	_____	_____

Notes \_\_\_\_\_

Driver **Standard Set-Up** Date \_\_\_\_\_ Track \_\_\_\_\_ Event \_\_\_\_\_

**Track Condition**

**Temperature**

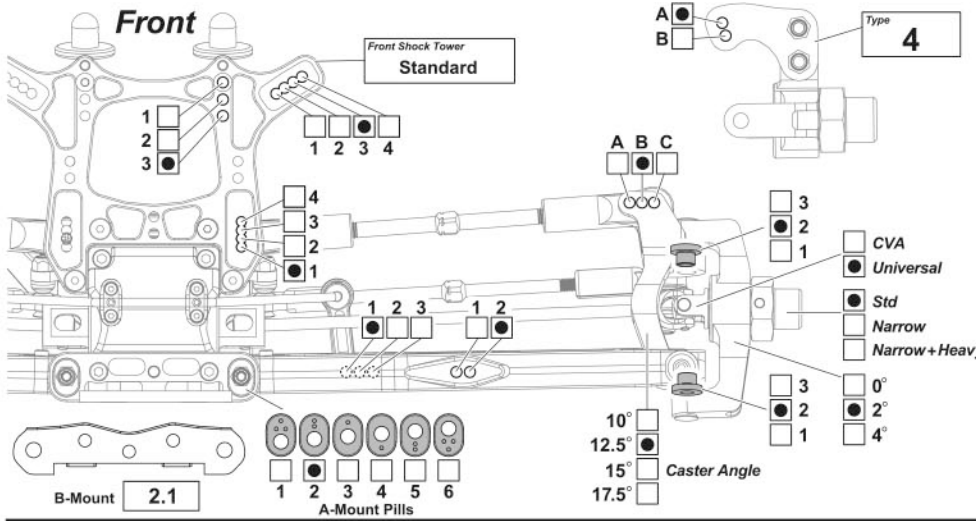

Ride Height: **37 mm**

Camber Angle: **2°**

Toe Angle: **1°**

Sway Bar: **2.6 mm**

Droop: **+6 mm**

Shock Length: **114 mm**

### Front Shocks

Oil weight: **35 wt**

Piston: **6 x 1.3 mm**

Bladder: **Std**

Spring: **Gold**

Notes: \_\_\_\_\_

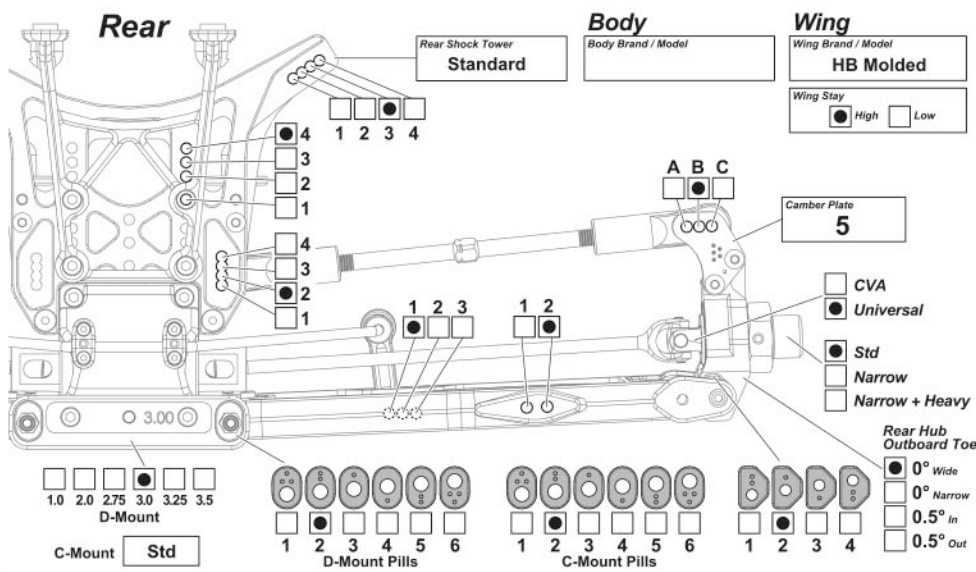

Ride Height: **40 mm**

Camber Angle: **3°**

Toe Angle: **3°**

Sway Bar: **2.8 mm**

Droop: **+3 mm**

Shock Length: **133 mm**

### Rear Shocks

Oil weight: **27.5 wt**

Piston: **6 x 1.3 mm**

Bladder: **Std**

Spring: **Orange**

Notes: \_\_\_\_\_

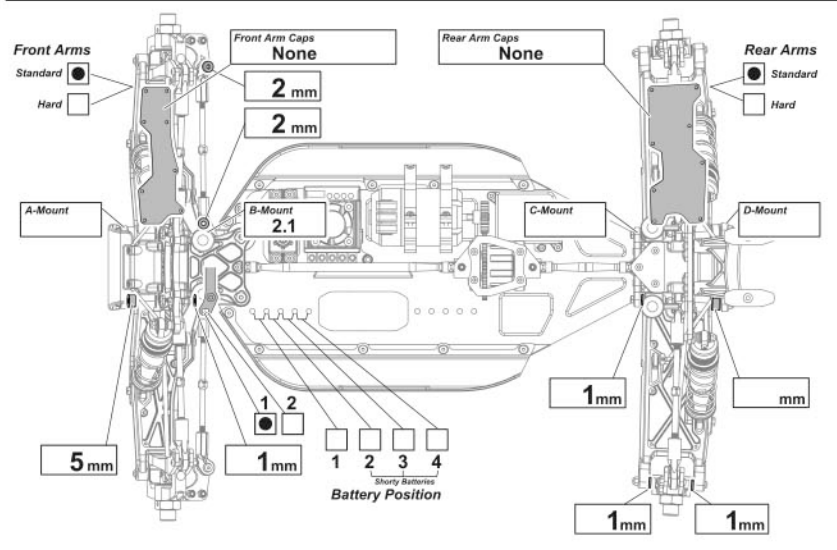

### Motor

Brand / Model: **Performa 2100**

Spur gear: **50**

Pinion Gear: **16**

### Battery

Brand / Model: **Performa 7700**

### ESC

Brand / Model: **Performa 150A**

### Tires

	Front	Rear
Brand	_____	_____
Compound	_____	_____
Insert	_____	_____
Wheel	_____	_____
Notes	_____	_____

### Diff Oils

	Front	Center	Rear
Brand	_____	_____	_____
Oil	<b>7000</b>	<b>7000</b>	<b>4000</b>

Notes

Driver **Standard Set-Up** Date \_\_\_\_\_ Track \_\_\_\_\_ Event \_\_\_\_\_

Track Condition \_\_\_\_\_ Temperature \_\_\_\_\_

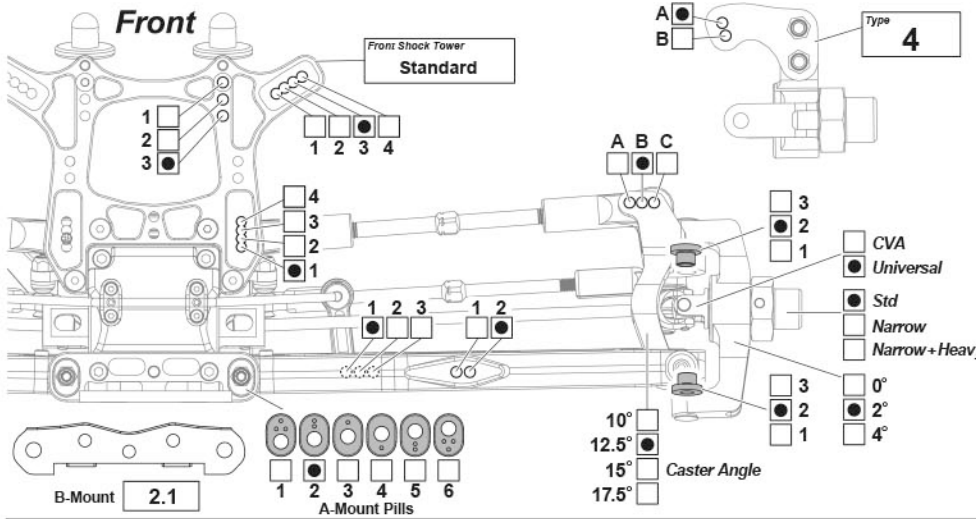

Ride Height: **37 mm**

Camber Angle: **2°**

Toe Angle: **1°**

Sway Bar: **2.6 mm**

Droop: **+6 mm**

Shock Length: **114 mm**

### Front Shocks

Oil weight: **35 wt**

Piston: **6 x 1.3 mm**

Bladder: **Std**

Spring: **Gold**

Notes: \_\_\_\_\_

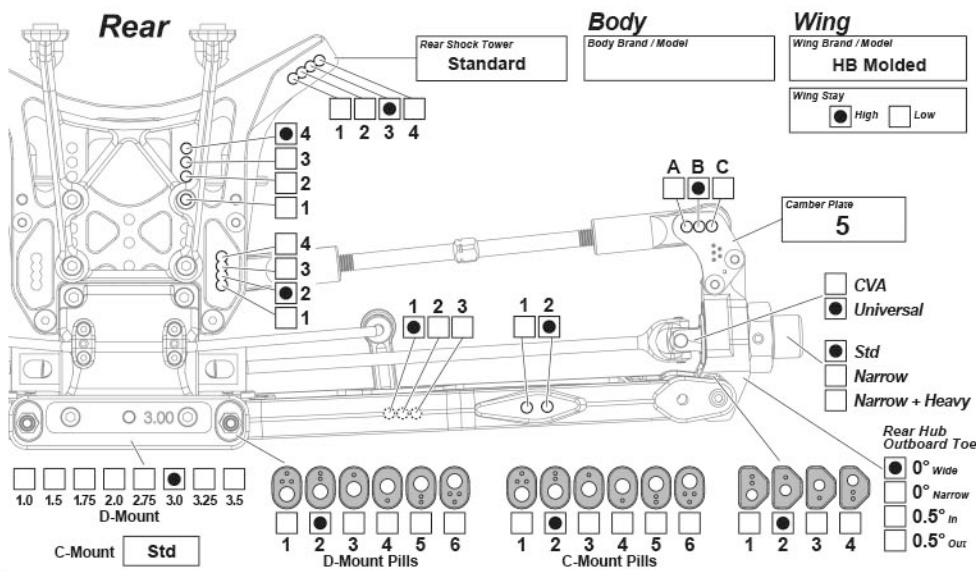

Ride Height: **40 mm**

Camber Angle: **3°**

Toe Angle: **3°**

Sway Bar: **2.8 mm**

Droop: **+3 mm**

Shock Length: **133 mm**

### Rear Shocks

Oil weight: **27.5 wt**

Piston: **6 x 1.3 mm**

Bladder: **Std**

Spring: **Orange**

Notes: \_\_\_\_\_

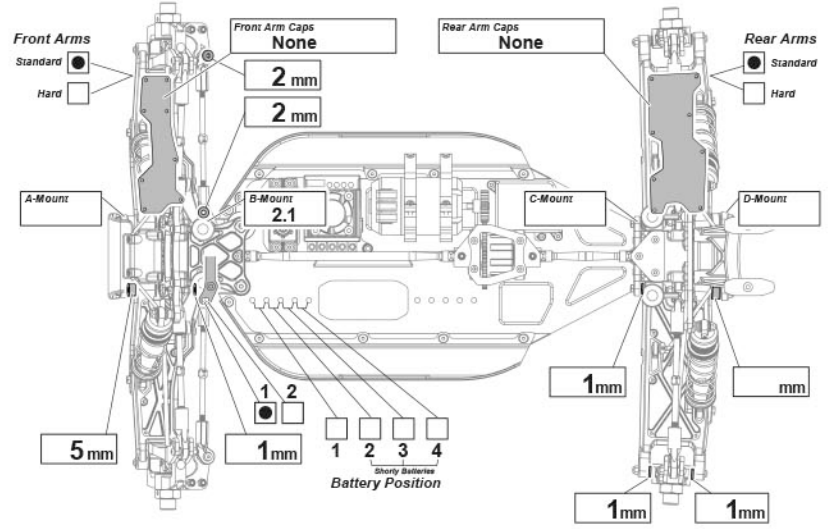

### Motor

Brand / Model: **Performa 2100**

Spur gear: **50**

Pinion Gear: **16**

### Battery

Brand / Model: **Performa 7700**

### ESC

Brand / Model: **Performa 150A**

### Tires

	Front	Rear
Brand	_____	_____
Compound	_____	_____
Insert	_____	_____
Wheel	_____	_____
Notes	_____	_____

### Diff Oils

	Front	Center	Rear
Brand	_____	_____	_____
Oil	<b>7000</b>	<b>7000</b>	<b>4000</b>

Notes

# Parts List

<b>PART #</b>	<b>DESCRIPTION</b>	<b>PART #</b>	<b>DESCRIPTION</b>
100550	PAN HEAD SCREW M5X8MM (HEX SOCKET/10PCS)	204608	CASTER BLOCK 12.5 (D8T/E8T EVO3)
100551	LOCK NUT M2.5 (4PCS)	204613	STEERING BLOCK 2 DEGREE (D8T/E8T EVO3)
100553	WASHER M2.9X8X0.5MM (8PCS)	204615	STEERING ARM TYPE 4 (D8T/E8T EVO3)
100554	SET SCREW M3X14MM (4PCS)	204616	STEERING RACK (D8T/E8T EVO3)
100556	FLAT HEAD SCREW M3X14MM (HEX SOCKET/10PCS)	204617	STEERING RACK BUSHING (D8T/E8T EVO3)
103671	FLANGED LOCK NUT M3 (10PCS)	204619	SHOCK TOWER REAR (D8T/E8T EVO3)
107372	DROOP SCREW M4X10MM (4PCS)	204620	REAR HUB (D8T/E8T EVO3)
109810	SHOCK SPRINGS (GOLD/68MM/79.6GF/2PCS)	204621	HUB ARM SET TYPE 5 (D8T/E8T EVO3)
109832	SHOCK BOOT (29MM STROKE/2PCS)	204622	UNIVERSAL REAR SET 128MM (D8T/E8T EVO3)
109834	SHOCK BOOT (38MM STROKE/2PCS)	204649	SHOCK STANDOFF 9MM ALUMINUM (2PCS)
109842	ARM MOUNT (A)	204651	SUSPENSION ARM FRONT & REAR SET (D8T/E8T EVO3)
109844	ARM MOUNT (C)	204655	KINGPIN V3 SET
109846	HINGE PIN BUSHING SET	204656	STEERING BLOCK BUSHING SET (D8T/E8T EVO3)
109847	PLASTIC SPACER SET	204657	CHASSIS (E8T EVO3)
109849	HINGE PIN SET (FRONT OUTER 2PCS)	204658	CHASSIS ROD FRONT (E8T EVO3)
109850	HINGE PIN SET (REAR OUTER 2PCS)	204659	CHASSIS ROD REAR (E8T EVO3)
109851	BUMPER	204660	DOGBONE 195MM SHORT PIN (E8T EVO3)
110112	ALUMINUM BALL 6.8X9X3MM (4PCS)	204661	DOGBONE 85MM SHORT PIN (E8T EVO3)
112738	BUTTON HEAD SCREW M2.5X8MM (HEX SOCKET/10PCS)	67202	LIGHTWEIGHT SHOCK STAND OFF (2PCS)
112794	WASHER SET 3X7MM (0.5MM/1.0MM/ORANGE/6PCS)	67204	LIGHT WEIGHT FIXING BALL (4PCS)
113476	SHOCK SPRINGS (ORANGE/83MM/82.1GF/2PCS)	67206	LIGHT WEIGHT STEERING PUSH ROD BALL (4PCS)
114414	WING MOUNT V2 (STANDARD)	67211	LIGHTWEIGHT DIFF AXLE SHAFT (2PCS)
114415	WING MOUNT V2 (+10MM)	67213	LIGHT WEIGHT SHOCK END BALL (4PCS)
114489	ALUMINUM WASHER 3X6X1.0MM (ORANGE/20PCS)	67289	BIG BORE SHOCK BODY (16X107MM/2PCS)
114721	AXLE BOOT (CENTER/REAR/4PCS)	67351	SHOCK END/SHOCK SPRING RETAINER SET
114744	SHOCK PISTON SET V2 (16MM/ORANGE/6 PAIRS)	67376	SERVO ARM SET
114746	FRONT SWAY BAR SET V2 (2.0, 2.2, 2.4, 2.6MM)	67394	SERVO SAVER CRANK SET
114747	REAR SWAY BAR SET V2 (2.2/2.4/2.6/2.8/3.0MM)	67397	STEERING CRANK SET
114749	ALUMINIUM SERVO SAVER ARM (BLACK)	67491	STEERING LINKAGE SET
114751	SERVO SAVER DUST COVER (4PCS)	67492	17MM WHEEL NUT (BLACK/4PCS)
114752	STEERING BRACE V2	67516	BALL END SET
114753	SHOCK CAP BUSHING (4PCS)	67528	BIG BORE SHOCK SPRING ADJUST NUT (BLACK/2PCS)
114754	SHOCK BELLOW BLADDER (4PCS)	67529	BIG BORE SHOCK BOTTOM CAP (BLACK/2PCS)
114755	CENTER BULKHEAD SET	67534	BALL 5.8X5.6MM (4PCS)
114761	BUTTON HEAD SCREW M2.5X6MM (HEX SOCKET/10PCS)	86598	WASHER 13X16X0.2MM (10PCS)
114762	INPUT SHAFT CLIP/SHIM SET (4PCS)	94531	FLAT HEAD SCREW M4X15MM (HEX SOCKET/10PCS)
114763	ALUMINIUM WING MOUNT WASHER (BLACK/2PCS)	94554	BUTTON HEAD SCREW M4X10MM (HEX SOCKET/10PCS)
114776	SHIM 4X10X0.3MM (12PCS)	94675	CAP HEAD SCREW M3.5X14MM (8PCS)
114777	SHOCK CARTRIDGE MAINTENANCE SET (1 PAIR)	94677	CAP HEAD SCREW M3.5X42MM (8PCS)
204000	CHASSIS BRACE CARBON SET (E817)	B028	BALL BEARING 6X10X3MM (2PCS)
204017	CHASSIS GUARD SET (817 SERIES)	B033	BALL BEARING 12X18X4MM (2PCS)
204018	FLUSH MOUNT FASTENER SCREW (M3.0/10PCS)	B034	BB 12X21X5MM (2PCS)
204020	BATTERY HOLDER SET (E817)	C8019	DIFFERENTIAL HOUSING
204021	BATTERY STRAP (E817)	C8021	DIFFERENTIAL PADS
204022	ELECTRONICS MOUNT SET (E817)	C8022	DIFFERENTIAL SHAFT
204027	D8 SERIES DIFF O-RINGS V2 (6MM/10PCS)	C8096	3X17MM SHAFT (4PCS)
204028	HINGE PIN INNER (2PCS/817 SERIES)	C8100	6.8MM BALL END (L) (4PCS)
204032	ARM MOUNT (D/3.00 DEG.)	C8101-1	HARD STEEL DIFFERENTIAL GEAR SET
204037	D8 SERIES GEARBOX SET (NEW)	Z084	FLAT HEAD SCREW M3X12MM (HEX SOCKET/10PCS)
204038	INPUT GEAR V2 (10T/E817)	Z086	FLAT HEAD SCREW M3X18MM (HEX SOCKET/10PCS)
204048	BODY MOUNT SET (817 SERIES)	Z150	ANTENNA PIPE SET
204055	WHEEL HEX, 17 X 6.7, LIGHT WEIGHT (4PCS/D817T)	Z216	BUTTON HEAD SCREW M3X15MM (HEX SOCKET/4PCS)
204080	BUTTON HEAD SCREW M3X25MM (6PCS)	Z224	WASHER M3X8MM (10PCS)
204081	MOTOR MOUNT SET (E817)	Z234	CAP HEAD SCREW M2X5MM (10PCS)
204083	FOAM ADHESIVE PAD (E817)	Z307	FLAT HEAD SCREW M4X10MM (HEX SOCKET/THIN TYPE/4PC)
204119	TURNBUCKLE M5 X 95MM (2PCS)	Z352	BUTTON HEAD SCREW M3X8MM (HEX SOCKET/10PCS)
204121	TURNBUCKLE M4 X 94MM (2PCS)	Z353	BUTTON HEAD SCREW M3X10MM (HEX SOCKET/10PCS)
204125	1:8 REAR WING (BLACK)	Z354	BUTTON HEAD SCREW M3X12MM (HEX SOCKET/10PCS)
204136	TURNBUCKLE M5 X 85MM (2PCS)	Z357	BUTTON HEAD SCREW M3X20MM (HEX SOCKET/10PCS)
204137	UNIVERSAL JOINT SET (FRONT/817T)	Z544	CAP HEAD SCREW M3X12MM (6PCS)
204146	SCREW TYP SHOCK PIN SET (LHX2 / RHX2)	Z546	CAP HEAD SCREW M3X18MM (10PCS)
204147	SET SCREW M4X25MM	Z547	CAP HEAD SCREW M3X20MM (6PCS)
204260	BB 8X16X5MM V2 (2PCS)	Z548	CAP HEAD SCREW M3X22MM (12PCS)
204424	BIG BORE SHOCK CAP SET V3 (2PCS)	Z663	LOCK NUT M3 (6PCS)
204456	D819 SWAYBAR PIVOT BALL V2 SET	Z676	LOCK NUT M3 THIN TYPE (4PCS)
204458	D819 1-PC SWAYBAR LINK (2PCS)	Z684	FLANGED LOCK NUT M4 (4PCS)
204477	ARM MOUNT 4-DOT (B+2.1MM)	Z700	SET SCREW M3X3MM (6PCS)
204562	D819 SERVO SAVER TUBE	Z702	SET SCREW M3X5MM (10PCS)
204569	SERVO SAVER SPRING (HARD)	Z721	SET SCREW M4X4MM (4PCS)
204595	CLAMPING SERVO SAVER NUT V2 (D819RS)	Z722	SET SCREW M4X5MM (8PCS)
204597	SHOCK SHAFT 33MM (D8T/E8T EVO3)	6203	BODY PIN (8MM/BLACK/LARGE/20PCS)
204598	SHOCK BODY 43MM (D8T/E8T EVO3)	66247	STEERING BALLEND 6.8MM (4PCS)
204599	SHOCK SHAFT 43MM (D8T/E8T EVO3)	67195	LIGHTWEIGHT STEERING POST (2PCS)
204600	DIFF RING 43-10 (D8T/E8T EVO3)	67197	LIGHTWEIGHT OUTDRIVES (2PCS)
204602	SPUR GEAR 50T (D8T/E8T EVO3)	67199	LIGHT WEIGHT BALL (6MM/4PCS)
204605	SHOCK TOWER FRONT (D8T/E8T EVO3)		

## Option Parts List

<i>PART #</i>	<i>DESCRIPTION</i>	<i>PART #</i>	<i>DESCRIPTION</i>
109806	SHOCK SPRINGS (GREEN/68MM/60.8GF/2PCS)	204253	ALUMINIUM THROTTLE SERVO HORN (23T)
109807	SHOCK SPRINGS (WHITE/68MM/64.6GF/2PCS)	204262	ALUMINIUM STEERING SERVO HORN (25T) V2
109808	SHOCK SPRINGS (BLUE/68MM/68.9GF/2PCS)	204263	ALUMINIUM STEERING SERVO HORN (23T) V2
109809	SHOCK SPRINGS (YELLOW/68MM/73.8GF/2PCS)	204264	RACING MFT TOOL
109811	SHOCK SPRINGS (RED/68MM/86.1GF/2PCS)	204444	FRONT SWAY BAR SET V2 (2.3, 2.5MM)
109812	SHOCK SPRINGS (GREEN/83MM/54.7GF/2PCS)	204445	REAR SWAY BAR SET V2 (2.5, 2.7MM)
109813	SHOCK SPRINGS (WHITE/83MM/57.9GF/2PCS)	204467	ENGINE MOUNT ADJUSTER NO.2 (4PCS)
109814	SHOCK SPRINGS (BLUE/83MM/61.6GF/2PCS)	204468	ENGINE MOUNT ADJUSTER NO.3 (4PCS)
109815	SHOCK SPRINGS (YELLOW/83MM/65.7GF/2PCS)	204476	ARM MOUNT 2-DOT (B/+0.7MM)
109816	SHOCK SPRINGS (GOLD/83MM/70.3GF/2PCS)	204565	D819 ARM MOUNT C (WIDE)
109817	SHOCK SPRINGS (RED/83MM/75.8GF/2PCS)	204607	CASTER BLOCK 10 (D8T/E8T EVO3)
109843	ARM MOUNT (B/0MM)	204609	CASTER BLOCK 15 (D8T/E8T EVO3)
114766	COMPETITION CLUTCH SPRING 0.9MM (3PCS)	204610	CASTER BLOCK 17.5 (D8T/E8T EVO3)
114767	COMPETITION CLUTCH SPRING 1.1MM (3PCS)	204611	CASTER BLOCK 20(D8T/E8T EVO3)
204053	ARM MOUNT (B/+1.4MM/817)	204612	STEERING BLOCK 0 DEGREE (D8T/E8T EVO3)
204054	ARM MOUNT (B/+2.8MM/817)	204614	STEERING BLOCK 4 DEGREE (D8T/E8T EVO3)
204250	ALUMINIUM THROTTLE SERVO HORN (25T)	204652	FRONT CARBON ARM STIFFENER SET (D8T/E8T EVO3)
204251	1:8 REAR WING (YELLOW)	204654	REAR CARBON ARM STIFFENER SET (D8T/E8T EVO3)
204252	1:8 REAR WING (WHITE)		

## NOTES

Serial Number  
Seriennummer  
Numéro de série



[www.hbracing.com](http://www.hbracing.com)  
Neidhart SA  
Ch. du Pré-Fleuri 31  
CH-1228 Plan-les-Ouates  
Switzerland  
Phone: +41 22 706 18 50